





---

**Acoraval** is a company with a wide experience in the metallic doors industry in general, and the security in particular.

At **Acoraval**, high tech is applied to the production by means of CNC numerical control machinery, automated elements that increase the speed of the production line, CAD CAM assisted designs, and the incorporation of a comprehensive system of ERP computerised management.

**Acoraval** develops management procedures for the continuous improvement, with standardized quality controls.

The primary objective, within our quality policy, is our clients' satisfaction and to contribute to meet their expectations, without forgetting the end user.







**AIDICO**  
INSTITUTO TECNOLÓGICO  
DE LA CONSTRUCCIÓN

00:49

39371 22/12/06



## Because peace of mind comes with feeling secure...

Acoraval contributes to secure the highest quality of life in the household. For that reason, we offer the following assets in our products:

**Security.** Compliance with the effraction resistance regulations (UNE-ENV 1628:2000, UNE-ENV 1629:2000, UNE-ENV 1930:2000). Level 3.

**Isolation.** Following the resistance regulations UNE EN 1634-1:2000, EI230 and EI260 and acoustic isolation to the aerial noise according to UNEEN ISO 140-3:1995, Air permeability UNE-EN 1026:2000, Air permeability UNE-EN 1027:2000, Resistance to wind load UNE-EN 12211:2000, Thermal transmittance UNE-EN-ISO 10077-2:2008 and UNE-EN-ISO 10077-1:2001.

**Functionality.** Facilitating the control of the entrance to the house incorporating new systems and mechanisms without less security.

**Esthétique.** Different harmonious designs using natural wood, PVC, resins and aluminium and steel sandwich panel, or customised for the client using pantograph and digitised printing.



**ACORAVAL, S.L.**  
C/ De Emilia Pardo Bazán, 38  
Pol. Ind. Els Mollons  
46970 ALAQUÀS  
(VALENCIA) ESPAGNE  
www.acoraval.com

10

### UNE-EN 14351 - 1: 2006

High security armored door, external pedestrian doorsets

Resistance to wind load -  
Test pressure: **Class 5**  
Resistance to wind load -  
Deflection: **Class C**  
Waterightness – Method (A): **Class 2A**  
Air permeability: – Method (B): **npd**  
Airborne sound insulation: **33 (-1; - 5)**  
Thermal transmittance: **2,3**  
Air permeability: **Class 1**  
Burglar resistance: **Class**



Performance	Store	Basic	S	S +	F 30	FS 30	FS 30 +	F 60	FS 60	FS 60 +
P1 Resistance to anti-burglary EN 1627/EN 85160	Degree 3	Degree 3	Degree 3	Degree 3	Degree 3	Degree 3	Degree 3	Degree 3	Degree 3	Degree 3
P2 Acoustic Insulation EN ISO 10140-2 ( Rw )		27 dB	37 dB	46 dB		37 dB	46 dB		37 dB	46 dB
P3 Fire Resistance EN 1634-1 (EI2 minutes)					EI2-30	EI2-30	EI2-30	EI2-60	EI2-60	EI2-60
P4 Thermic Insulation EN ISO 10077-1 (Ud)			1,5 W/m² K	1,5 W/m² K		1,5 W/m² K	1,5 W/m² K		1,5 W/m² K	1,5 W/m² K
P5 Air Permeability EN 1026				Degree 1			Degree 1			Degree 1
P6 Watertightness EN 1027				Degree 2A			Degree 2A			Degree 2A
P7 Restistance against wind pressure EN 12211				Degree C			Degree C			Degree C

## Assembly of the inner sub-frame

The sub-frame must be based on the finished floor. Otherwise, leave enough space to place the floor (see fig 1). The floor must never be built-in (see fig 2).

The thickness of the finished wall must be equal to the sub-frame ordered by the client (see fig 3). No part of the wall can exceed the thickness of the sub-frame (see fig 4).

In case of having some perpendicular wall to the one that bears the subframe, in any of its parts, this wall has to be a minimum of 7 cm. (A) apart to be able to install the door correctly (see fig 5). The wall can never be on the same level or less than 7 cm. (a).

The struts of the sub-frame must not be disassembled until the sub-frame holds and is set in the building.

The sub-frame must be perfectly plumbed to both sides in order to avoid any problems installing door.

The anchorage claws of both the metallic and the wood part will have to be opened in order to be able to be set in the building (see figures 3 and 5).

Each sub-frame comes with its appropriate building assembly instructions.



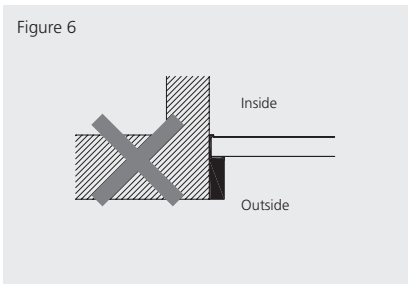
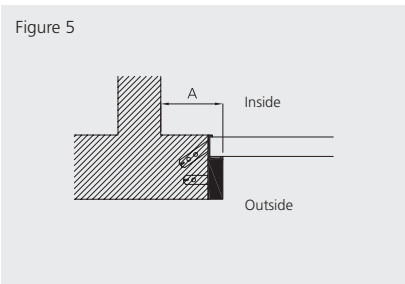
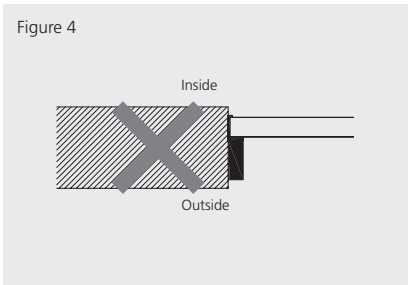
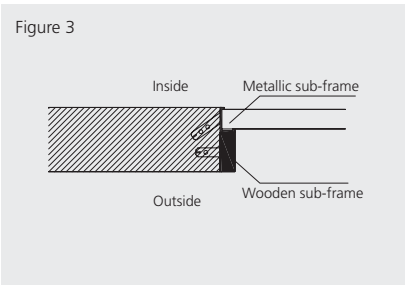
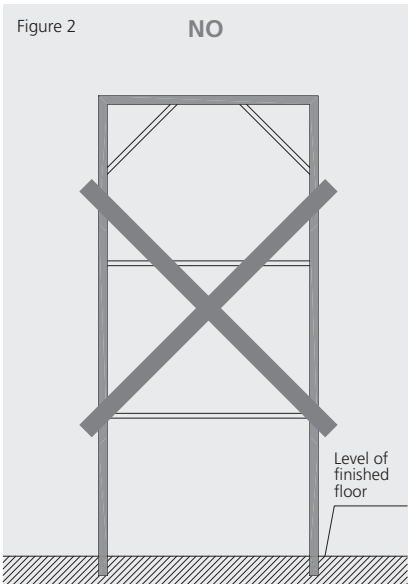
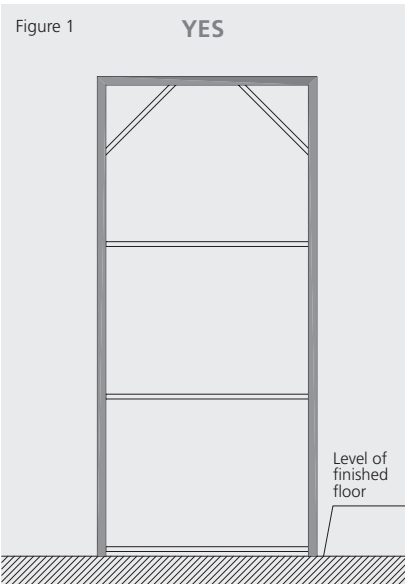
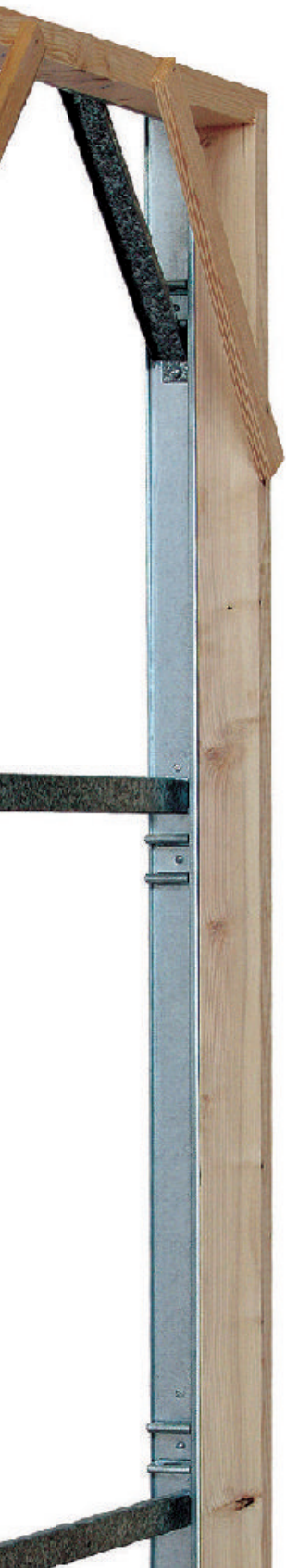



## Assembly of the outer sub-frame

The sub-frame must be based on the finished floor. Otherwise, leave enough space to place the floor (see fig 1). The floor must never be built-in (see fig 2).

The finishing material of the outer façade must end on and within the limit of the levelling platen, following the directions of the red coloured band (see fig 7).

In case of having some perpendicular wall to the one that bears the subframe, in any of its parts, this wall has to be a minimum of 7 cm. (A) apart to be able to install the door correctly (see fig 5). The wall can never be on the same level or less than 7 cm. (a).

The struts of the sub-frame must not be disassembled until the sub-frame holds and is set in the building.

The sub-frame must be perfectly plumb to both sides in order to avoid any problems installing door.

The anchorage claws of the metallic sub-frame will have to be opened in order to be able to be set in the building (see fig 8).

It is advisable to follow the brick laying indicated in figure 9 for a greater agility in the construction of the doorway that will bear the door.

Each sub-frame comes with its appropriate building assembly instructions.



## Example of section of door 80

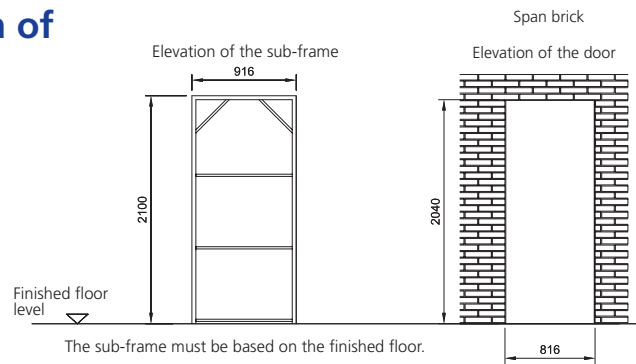

Levelling platen with finishing material of the façade

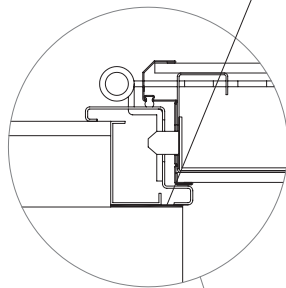

Figure 8

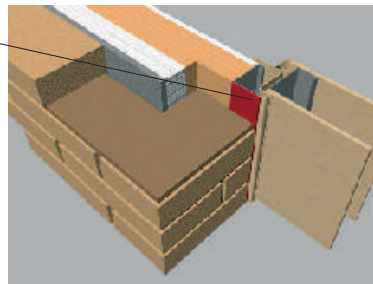

Figure 7

Twist the claws of the sub-frame and put it on a resistant wall

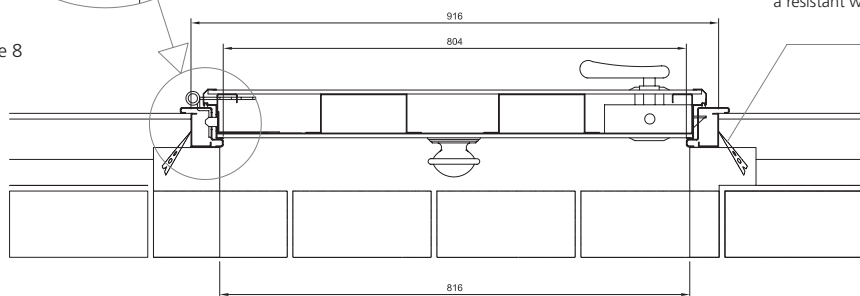
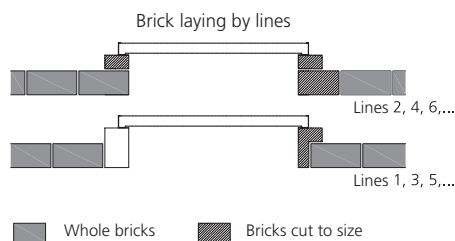

Figure 9



## Assembly and regulation of the door

For further information about the assembly of the door, download the installation video in the download area of [www.acoraval.com](http://www.acoraval.com)

### 1. Adjustment of the door frame

Regulating the position of the T-shaped claw clip you can adjust the frame for small deviations from the plumbing of the sub-frame.

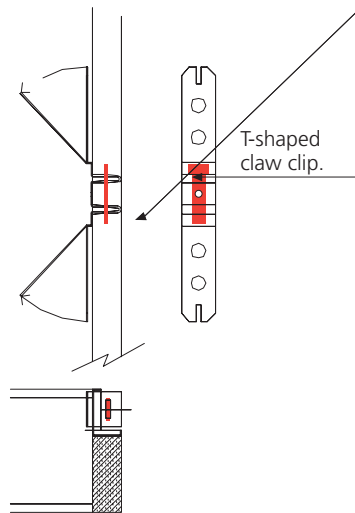

On the claw clip we screw together (M8) the door frame when the subframe is placed.

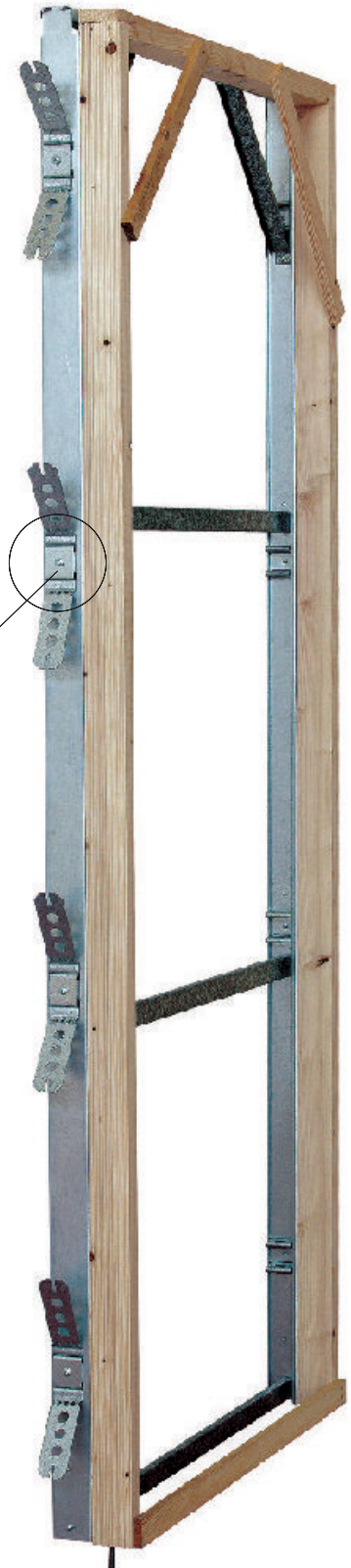





## 2. Adjustment of the tilt of the leaf in the hinge.

Positions to adjust the tilting of the leaf in each hinge.



## 3. Height adjustment of the leaf in the hinge.

Height adjustment of the leaf in each hinge using an Allen key.

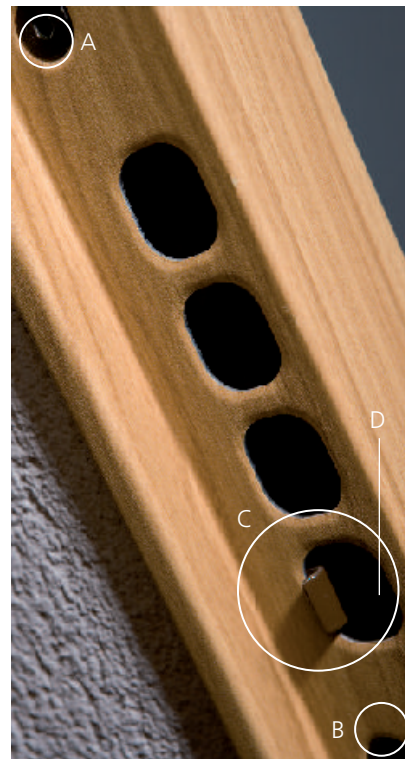

## 4. Adjustment of the looseness of the leaf when closing.

Loosening the screws indicated in figure (A and B) it is possible to move the inner piece (C) that includes the anti-card system, so that the opposite piece comes out and stops the latch.

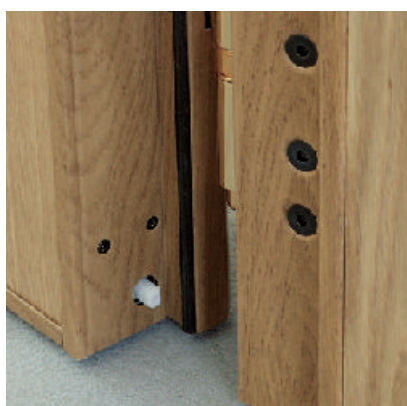

## 5. Adjustment of Draught excluder.

To move the plastic piece we can use its central screw. The draught excluder pressed into the leaf are operated when closing it.

## Assembly of the lock cylinder, and the Defender

Cylinder protecting piece or defender consisting of an external ring in bronze, matt nickel and matt gold finishing, and a solid steel anti-drill and antiextraction piece that becomes a single part when joined to the internal lock.

Figure 1

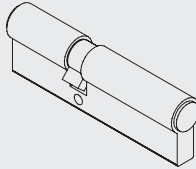

Figure 2

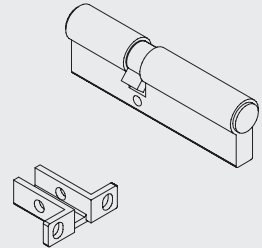

Figure 3

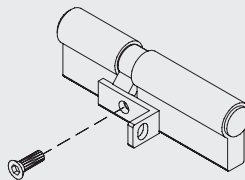

Figure 4. Cylinder protection or Defender\*

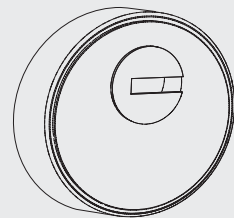
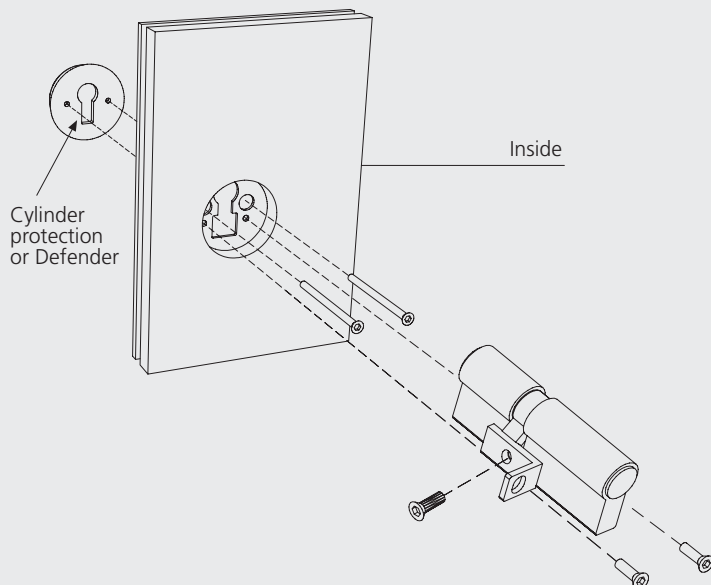

Figure 5



## Assembly of the door handle

Diagram of the door handle and the Defender

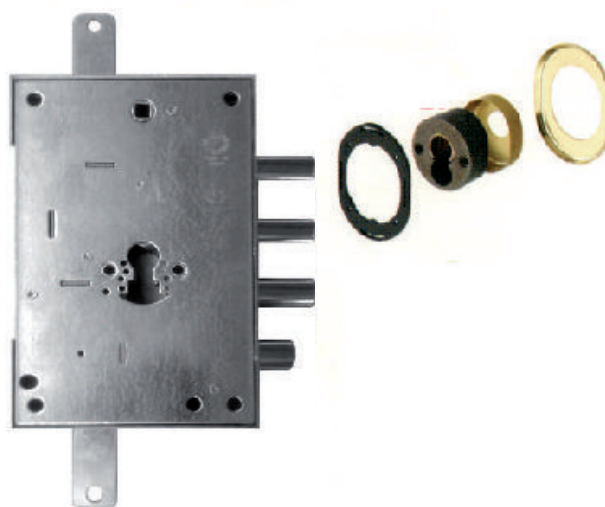

Diagram of the knob.



Diagram of the restrictive opening knob.





## Security and internal structure



High security cylinder  
with 10 pins + construction  
key



Lock with dead bolts  
of 18 mm of diameter



Defender cylinder



Anti-lever bolts x 3



Restrictive opening knob

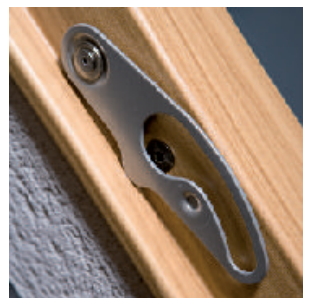

Panel of 85 mm. thickness  
Optionally 3 lock points

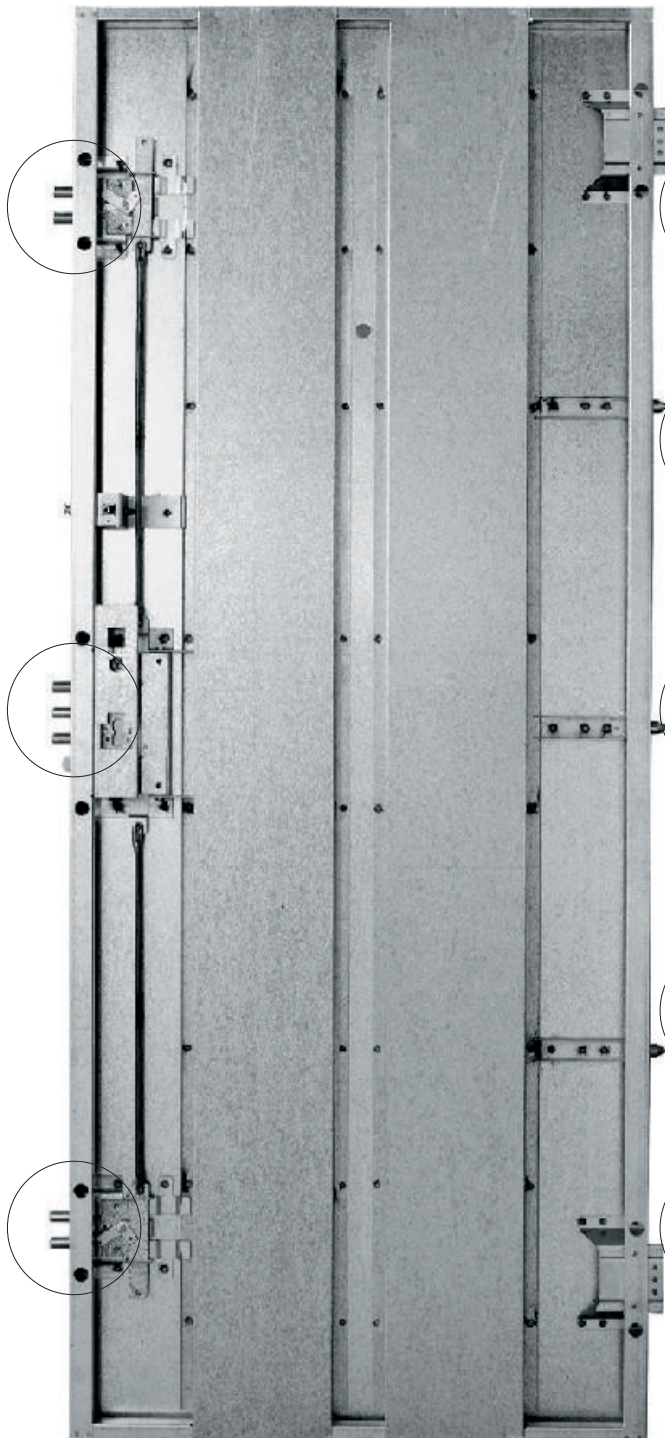

Panel of 85 mm. thickness  
Optionally 5 lock points

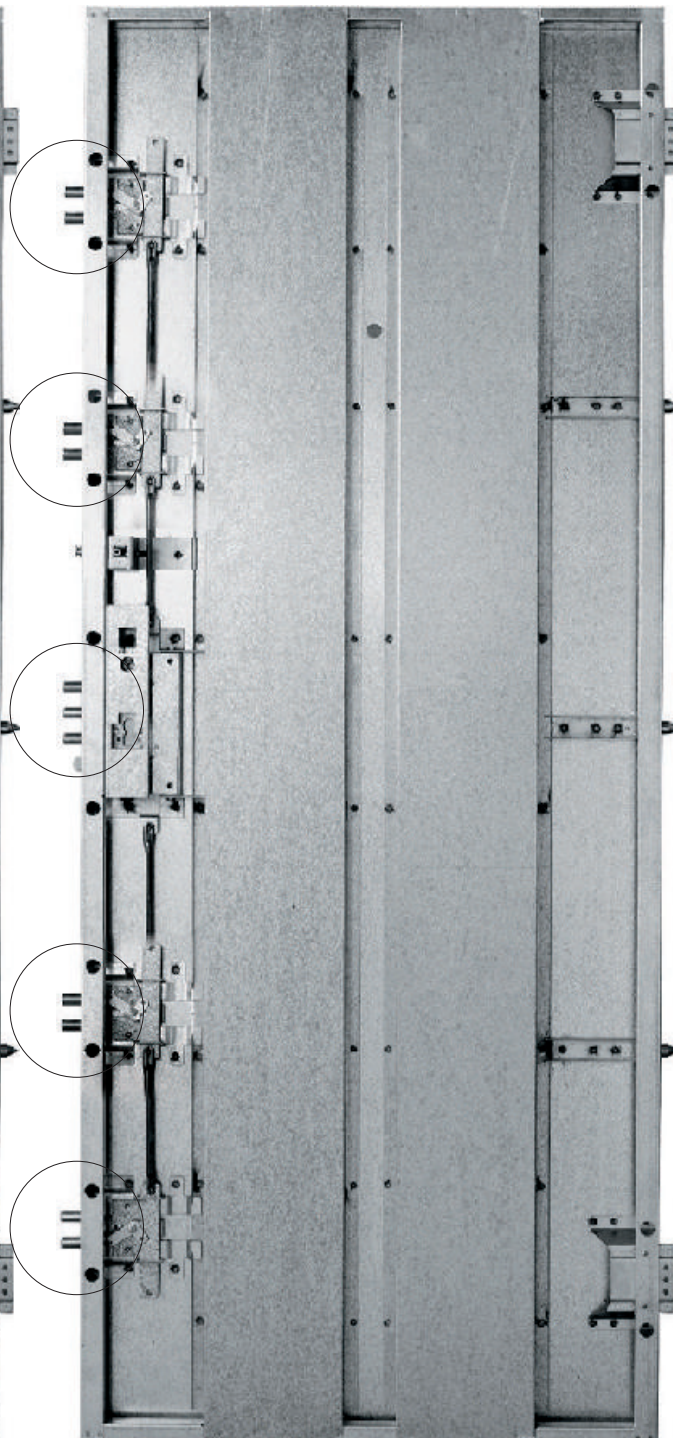

## Elements of security

### Lock bolt half turn electric (doorman automatic)

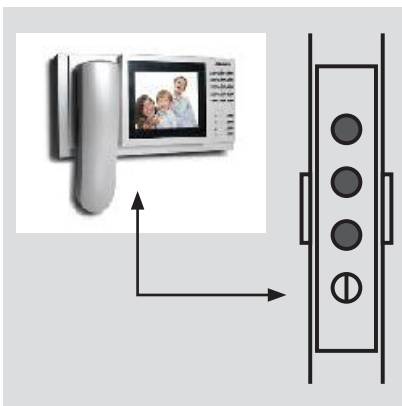

With this option we get a remote control via an intercom or a door knob and we keep a minimum of security since the latch bolt butte is the own frame directly and not a device for opening doors to the magnetic action.

This lock offers guarantees of highest security, more than conventional and their difference is that the latch bolt can be electronically operated.

### Clutch cylinder double

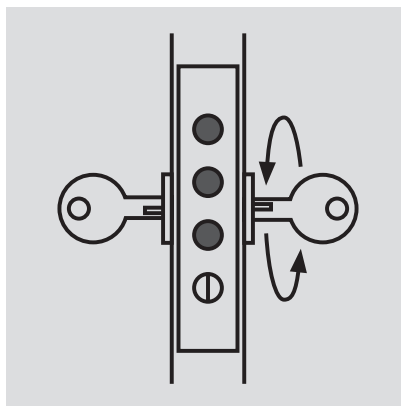

This cylinder option presents an interesting feature in this concerning the utility involved for open the lock even if in the parte inside the dwelling there is another key inserted in the cylinder.

This is a usual circumstance and that's why we want to offer this benefit to our customers. In that case, and with a cylinder without clutch double, he could not operate the lock because it would be blocked and we could not get into our home.

### Lock higher degree of security, class 7, according to the EN 12209 standard: 2005. Resistance to perforation

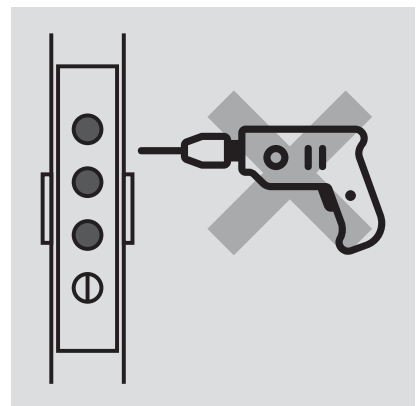

Our locks have a maximum level of anti-drilling safety, to protect the locking mechanism against malicious intrusions.



## Key lock with groove

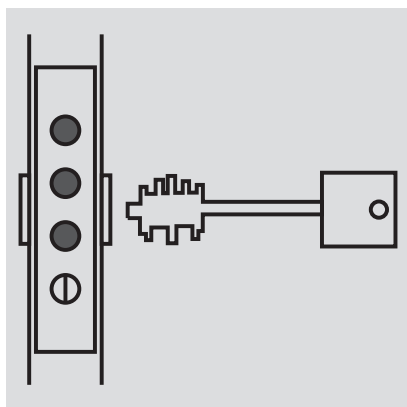

This option is also possible with our door, ask for everything simply as we have titled here. It is a variant of the european cylinder key lock, being the latter the most common. Some areas are more common to use one or the other so that he must specify what is you prefer.

## Lock with system locking in extraction case or rupture of the cylinder

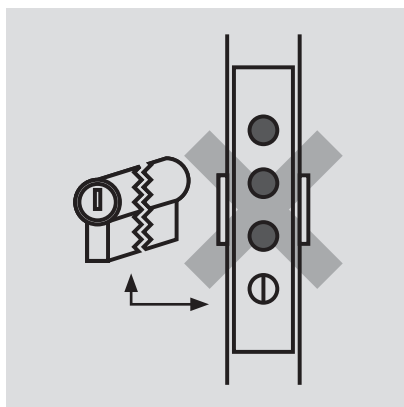

It's a very interesting system that we offer as an option, and in which occur a blockage of the lock when someone tries to remove or break the cylinder the latter. This technique is quite common and unfortunately effective, if despite the protection of the cylinder offered in series, someone gets access to the cylinder, breaking or retirement, this option ensures the locking the lock preventing the opening of the door.

## Double lock cylinder for the staff

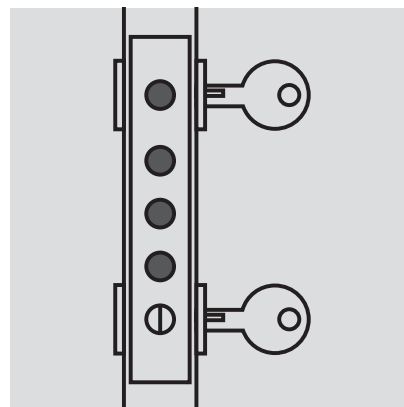

Normally this type of lock provides very basic access control, in which one of the two cylinders is the main one that predominates relative to each other, so that in activating the entire cylinder mechanism principal, we cancel any option secondary opening. Familiarly known as the lock of service.

## Elements of security

### Anti-bumping cylinders

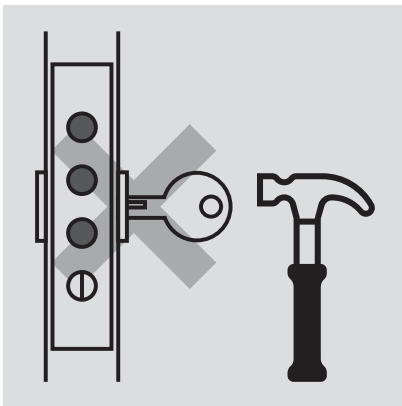

We can integrate a great variety of cylinders of European profile on our doorstep, from the series model with 10 pins, up to the cylinder on more sophisticated with exclusive patent of security. As an example, we can highlight the cylinders anti-bumping that guarantee the not opening with techniques of bumping, and control cylinders basic access like those of staff.

### Anti-panic lock

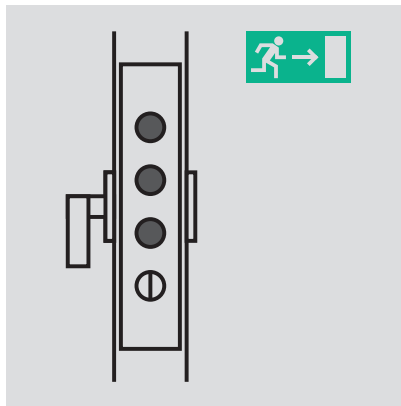

If we equip our lock doors anti-panic, we ensure, in the case of an emergency door, that we can go out by the said door without using keys or complex systems opening. So by simple pressure of the handle the lock unlocks and the door opens.

## Motorized lock

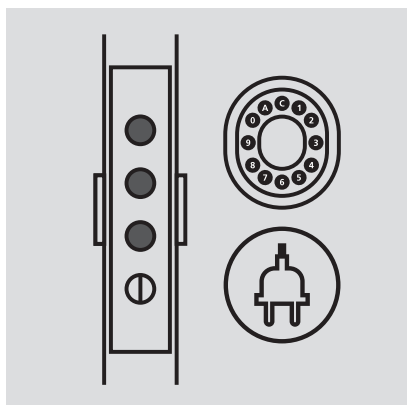

There is a very interesting option that we can offer and in which we always ensure that the lock is in place of maximum security, that is, with all the tricks given. This lock is motorized and automatic. In addition, the opening can be transponder and keyboard, two possibilities included in the option, in addition, the mechanical key. She is fully programmable and we recommend that programming of the lock either to operate the bolts when the door is closed.

See more options of this lock in last section of this catalog, like the GSM module to open the door with an SMS message, the alarms, fingerprints, accessibility for people disabled, etc.

## Selective access cylinder

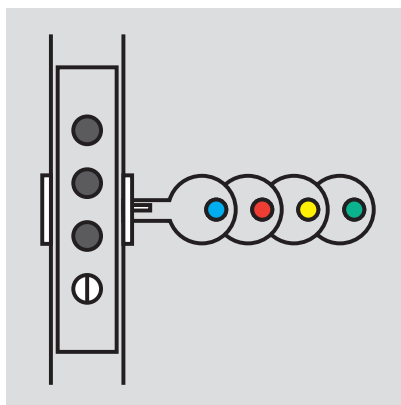

It is a system patented by the manufacturer that allows control selective access simply with the help of the keys and the same cylinder. We offer as an alternative option to our already cited as 'lock double cylinder for staff "service" since the function is the same. Operation is the next: the three blue keys are to the owner, and serve as pass all over. The three yellow keys are to service personnel as key user. Red key inactive yellow keys. The green key activates the yellow keys.

## Assembly instructions of high security armoured doors



### Mounting interior is realized inside buildings.

To preserve wooden elements.

The sequence assembly will be the next:

- 1) Attach the pre-frame to the wall.
- 2) Screw the pre-frame.
- 3) Fit the door.
- 4) Adjust the door.
- 5) Place the attached cover and dressing.

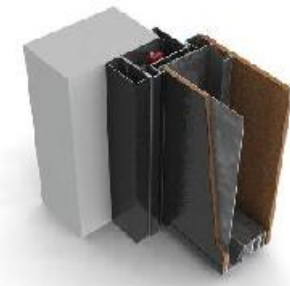

### Outside mounting, finish covers metal seal.

Outdoor mounting is done outdoors buildings. In using a joint cover to hide the pre-frame.

The sequence assembly will be the next:

- 1) Attach the pre-frame to the wall.
- 2) Screw the joint cover metallic.
- 3) Screw the frame.
- 4) Fit the door.
- 5) Adjust the door.

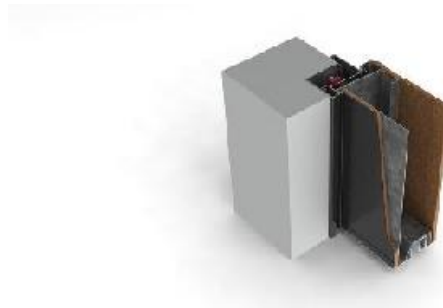

### Outside mounting, finishing work.

Le montage d'extérieur est réalisé à l'extérieur des bâtiments. Utilisation des travaux de finition pour couvrir le pré cadre.

The assembly sequence will be as follows:

- 1) Attach the pre-frame to the wall.
- 2) Screw the pre-frame.
- 3) Fit the door.
- 4) Adjust the door.

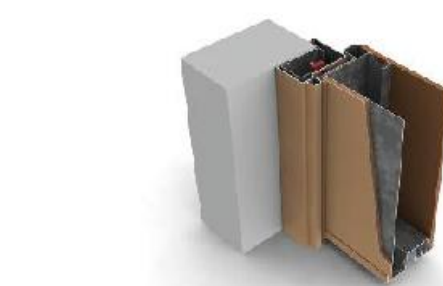

### Frame mounting direct leaf inside/outside.

The mounting frame direct is carried out outside as at inside. The difference is that the door is delivered with the pre-frame ready for on-site assembly.

The sequence assembly will be the next:

- 1) Attach the pre-frame to the wall.
- 2) Adjust the door





### Interior mounting with pre-frame screwed.

The assembly in the inside is done inside buildings. For preserve the elements wooden claws are replaced by screws.

The sequence assembly will be the next:

- 1) Screw the pre-frame.
- 2) Screw the frame.
- 3) Fit the door.
- 4) Adjust the door.
- 5) Place seal covers and dressing.



### Wall mounting dried.

We use a clamp special who makes contact with the partition resist.

The sequence assembly will be the next:

- 1) Attach the pre-frame to the wall.
- 2) Screw the pre-frame.
- 3) Fit the door.
- 4) Adjust the door.
- 5) Place seal covers and dressing.



### Montage reform, without pre-framework.

The sequence assembly will be the next:

- 1) Mill the old pre-frame.
- 2) Plumb and screw the frame.
- 3) Fit the door.
- 4) Adjust the door.

Dimensions of the door



Dimensions of the doorway				
	2014	2034	2134	2434
724	•			
804	•	•	•	•
904		•	•	•

Profile colours



Frame profile



Leaf profile

Finishing

Single colour PVC

PVC Wood

Lacquered Polyester

Brown	White	Silver	Oakwood	Cherrywood	Beechwood	Wenge	Walnut	RAL Standard	RAL with textures
									

## Mouldings

It is positioned exclusively on the outer side of the house since the frame overlaps on the inside.

For doors placed outside we advise not to use the moulding kit since it can be finished directly with the building (refer to the assembly of the external subframe page).

### Moulding Kits

Shaped / Plain

Plain / Plain

Qualities depend on the chosen panel for the leaf.

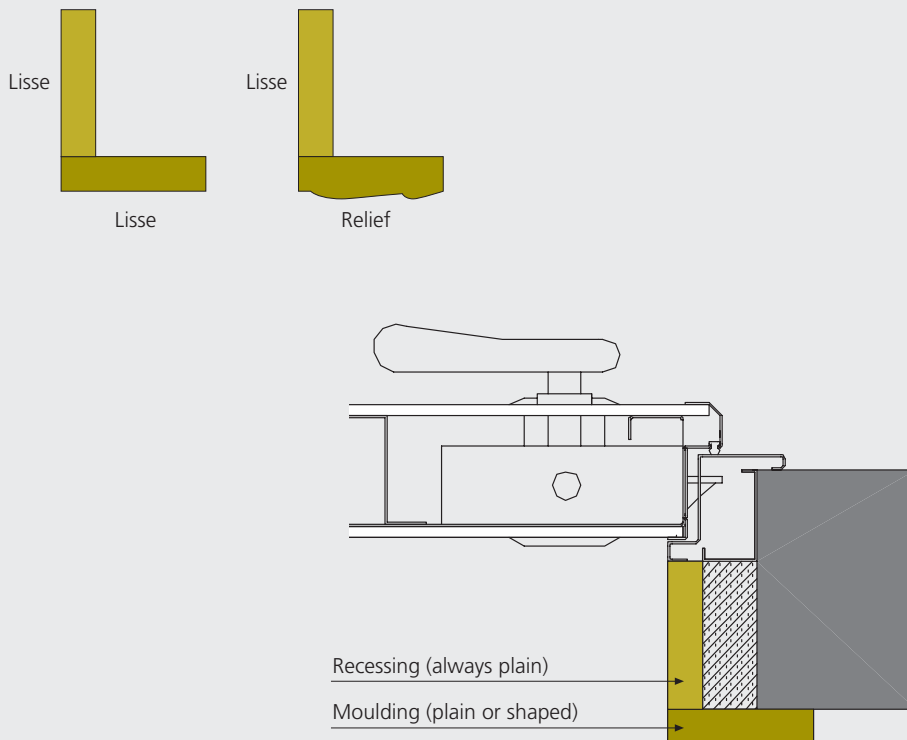



## Options of door + fixed panel

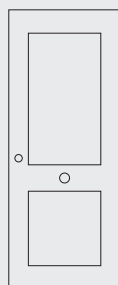

Door

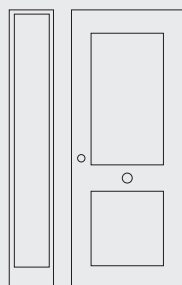

Door with left  
fixed panel

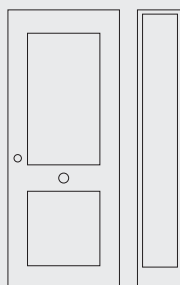

Door with right  
fixed panel

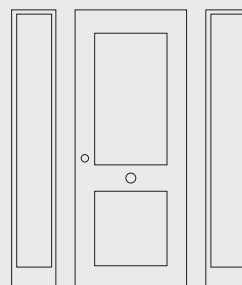

Door with two fixed  
lateral panels

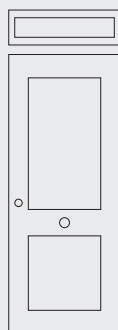

Door with  
top fixed  
panel

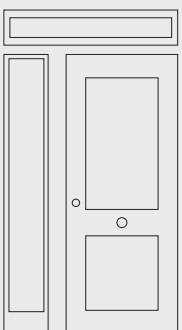

Door with top and  
left fixed panel

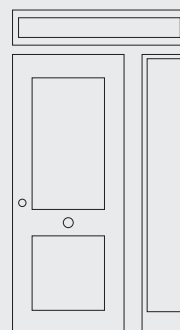

Door with top and  
right fixed panel

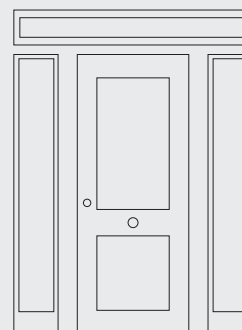

Door with top, left  
and right fixed  
panel

## Combinations fixed panels

Mesures mm effective span or door way				Mesures mm fitting span wall for sub-frame	Mesures mm fitting span brick <sup>1</sup>
Door 724x2014	Door 804x2014	Fixed 291	Fixed 416		
1				836 x 2080	736 x 2020
1		1 lateral		1280 x 2080	1180 x 2020
1			1 lateral	1405 x 2080	1305 x 2020
1		1 lateral	1 top	1280 x 2649	1180 x 2589
1		1 top	1 lateral	1405 x 2524	1305 x 2464
1		1 lat+1 top		1280 x 2524	1180 x 2464
1			1 lat+1 top	1405 x 2649	1305 x 2589
1		2 lateral		1784 x 2080	1684 x 2020
1			2 lateral	2034 x 2080	1934 x 2020
1		1 top		836 x 2524	736 x 2464
1			1 top	836 x 2649	736 x 2589
1		2 lat + 1 top		1784 x 2524	1684 x 2464
1			2 lat + 1 top	2034 x 2649	1934 x 2589
1		2 lateral	1 top	1784 x 2649	1684 x 2589
1		1 top	2 lateral	2034 x 2524	1934 x 2464
	1			916 x 2080	816 x 2020
	1	1 latéral		1360 x 2080	1260 x 2020
	1		1 lateral	1485 x 2080	1385 x 2020
	1	1 lateral	1 top	1360 x 2649	1260 x 2589
	1	1 top	1 lateral	1485 x 2524	1385 x 2464
	1	1 lat+1 top		1360 x 2524	1260 x 2464
	1		1 lat+1 sup	1485 x 2649	1385 x 2589
	1	2 lateral		1864 x 2080	1764 x 2020
	1		2 lateral	2114 x 2080	2014 x 2020
	1	1 top		916 x 2524	816 x 2464
	1		1 supérieur	916 x 2649	816 x 2589
	1	2 lat + 1 sup		1864 x 2524	1764 x 2464
	1		2 lat + 1 sup	2114 x 2649	2014 x 2589
	1	2 lateral	1 top	1864 x 2649	1764 x 2589
	1	1 top	2 lateral	2114 x 2524	2014 x 2464

1. In case of installation of outside door, completion of the construction site, and without moulding kit, see page 9.



## Combinations fixed panels

Mesures mm effective span or door way				Mesures mm fitting span wall for sub-frame	Mesures mm fitting span brick <sup>1</sup>
Door 804x2034	Door 904x2034	Fixed 291	Fixed 416		
1				916 x 2100	816 x 2040
1		1 lateral		1360 x 2100	1260 x 2040
1			1 lateral	1485 x 2100	1385 x 2040
1		1 lateral	1 supérieur	1360 x 2669	1260 x 2609
1		1 top	1 lateral	1485 x 2544	1385 x 2484
1		1 lat + 1 top		1360 x 2544	1260 x 2484
1			1 lat + 1 top	1485 x 2669	1385 x 2609
1		2 latéraux		1864 x 2100	1764 x 2040
1			2 lateral	2114 x 2100	2014 x 2040
1		1 top		916 x 2544	816 x 2484
1			1 top	916 x 2669	816 x 2609
1		2 lat + 1 top		1864 x 2544	1764 x 2484
1			2 lat + 1 top	2114 x 2669	2014 x 2609
1		2 lateral	1 top	1864 x 2669	1764 x 2609
1		1 top	2 lateral	2114 x 2544	2014 x 2484
	1			1016 x 2100	916 x 2040
	1	1 lateral		1485 x 2100	1385 x 2040
	1		1 lateral	1610 x 2100	1510 x 2040
	1	1 lateral	1 top	1485 x 2694	1385 x 2634
	1	1 top	1 latéral	1610 x 2569	1510 x 2509
	1	1 lat + 1 top		1485 x 2569	1385 x 2509
	1		1 lat + 1 top	1610 x 2694	1510 x 2634
	1	2 lateral		1984 x 2100	1884 x 2040
	1		2 lateral	2234 x 2100	2134 x 2040
	1	1 top		1016 x 2544	916 x 2484
	1		1 top	1016 x 2669	916 x 2609
	1	2 lat + 1 top		1984 x 2569	1884 x 2509
	1		2 lat + 1 top	2234 x 2694	2134 x 2634
	1	2 lateral	1 top	1984 x 2694	1884 x 2634
	1	1 top	2 lateral	2234 x 2569	2134 x 2509

1. In case of installation of outside door, completion of the construction site, and without moulding kit, see page 9.



Mesures mm effective span or door woy				Mesures mm fitting span wall for sub-frame	Mesures mm fitting span brick <sup>1</sup>
Door 804x2134	Door 904x2134	Fixed 291	Fixed 416		
1				916 x 2200	816 x 2140
1		1 lateral		1360 x 2200	1260 x 2140
1			1 lateral	1485 x 2200	1385 x 2140
1		1 lateral	1 top	1360 x 2769	1260 x 2709
1		1 top	1 lateral	1485 x 2644	1385 x 2584
1		1 lat + 1 top		1360 x 2644	1260 x 2584
1			1 lat + 1 top	1485 x 2769	1385 x 2709
1		2 lateral		1864 x 2200	1764 x 2140
1			2 lateral	2114 x 2200	2014 x 2140
1		1 supérieur		916 x 2644	816 x 2584
1			1 top	916 x 2769	816 x 2709
1		2 lat + 1 top		1864 x 2644	1764 x 2584
1			2 lat + 1 top	2114 x 2769	2014 x 2709
1		2 lateral	1 top	1864 x 2769	1764 x 2709
1		1 top	2 lateral	2114 x 2644	2014 x 2584
	1			1016 x 2200	916 x 2140
	1	1 latéral		1485 x 2200	1385 x 2140
	1		1 latéral	1610 x 2200	1510 x 2140
	1	1 latéral	1 top	1485 x 2794	1385 x 2734
	1	1 top	1 latéral	1610 x 2669	1510 x 2609
	1	1 lat + 1 top		1485 x 2669	1385 x 2609
	1		1 lat + 1 top	1610 x 2794	1510 x 2734
	1	2 lateral		1984 x 2200	1884 x 2140
	1		2 lateral	2234 x 2200	2134 x 2140
	1	1 top		1016 x 2644	916 x 2584
	1		1 top	1016 x 2769	916 x 2709
	1	2 lat + 1 top		1984 x 2669	1884 x 2609
	1		2 lat + 1 top	2234 x 2794	2134 x 2734
	1	2 lateral	1 top	1984 x 2794	1884 x 2734
	1	1 top	2 lateral	2234 x 2669	2134 x 2609
Door 804 x 2434	Door 904 x 2434	Fixed 291	Fixed 416		
1				916 x 2500	816 x 2440
1		1 lateral		1360 x 2500	1260 x 2440
1			1 lateral	1485 x 2500	1385 x 2440
1		2 lateral		1864 x 2500	1764 x 2440
1			2 lateral	2114 x 2500	2014 x 2440
	1			1016 x 2500	916 x 2440
	1	1 lateral		1485 x 2500	1385 x 2440
	1		1 lateral	1610 x 2500	1510 x 2440
	1	2 lateral		1984 x 2500	1884 x 2440
	1		2 lateral	2234 x 2500	2134 x 2440

1. In case of installation of outside door, completion of the construction site, and without moulding kit, see page 9.



## Table of dimensions with fixed panels

		Mesures fitting span wall for sub-frame <span>span wall for sub-frame</span>													
Width mm	Mesures fitting span wall for sub-frame		2080	2100	2200	2500	2524	2544	2569	2644	2649	2669	2694	2769	2794
		836	●				●				●				
		916	●	●	●	●	●	●		●	●	●		●	
		1016		●	●	●		●		●		●		●	
		1280	●				●				●				
		1360	●	●	●	●	●	●		●	●	●		●	
		1405	●				●				●				
		1485	●	●	●	●	●	●	●	●	●	●	●	●	●
		1610		●	●	●			●			●	●		●
		1784	●				●				●				
		1864	●	●	●	●	●	●		●	●	●		●	
		1984		●	●	●			●			●	●		●
		2034	●				●				●				
		2114	●	●	●	●	●	●		●	●	●		●	
		2234		●	●	●			●			●	●		●

		Height mm.													
Width mm	Mesures fitting span brick <sup>1</sup>	Mesures fitting span brick <sup>1</sup>													
			2020	2040	2140	2440	2464	2484	2509	2584	2589	2609	2634	2709	2734
		736	●				●				●				
		816	●	●	●	●	●	●		●	●	●		●	
		916		●	●	●		●		●		●		●	
		1180	●				●				●				
		1260	●	●	●	●	●	●		●	●	●		●	
		1305	●				●				●				
		1385	●	●	●	●	●	●	●	●	●	●	●	●	●
		1510		●	●	●			●			●	●		●
		1684	●				●				●				
		1764	●	●	●	●	●	●		●	●	●		●	
		1884		●	●	●			●			●	●		●
		1934	●				●				●				
		2014	●	●	●	●	●	●		●	●	●		●	
		2134		●	●	●			●			●	●		●

1. In case of installation of outside door, completion of the construction site, and without moulding kit, see page 9.

## Door dimensions for assembly on old wooden sub-frame

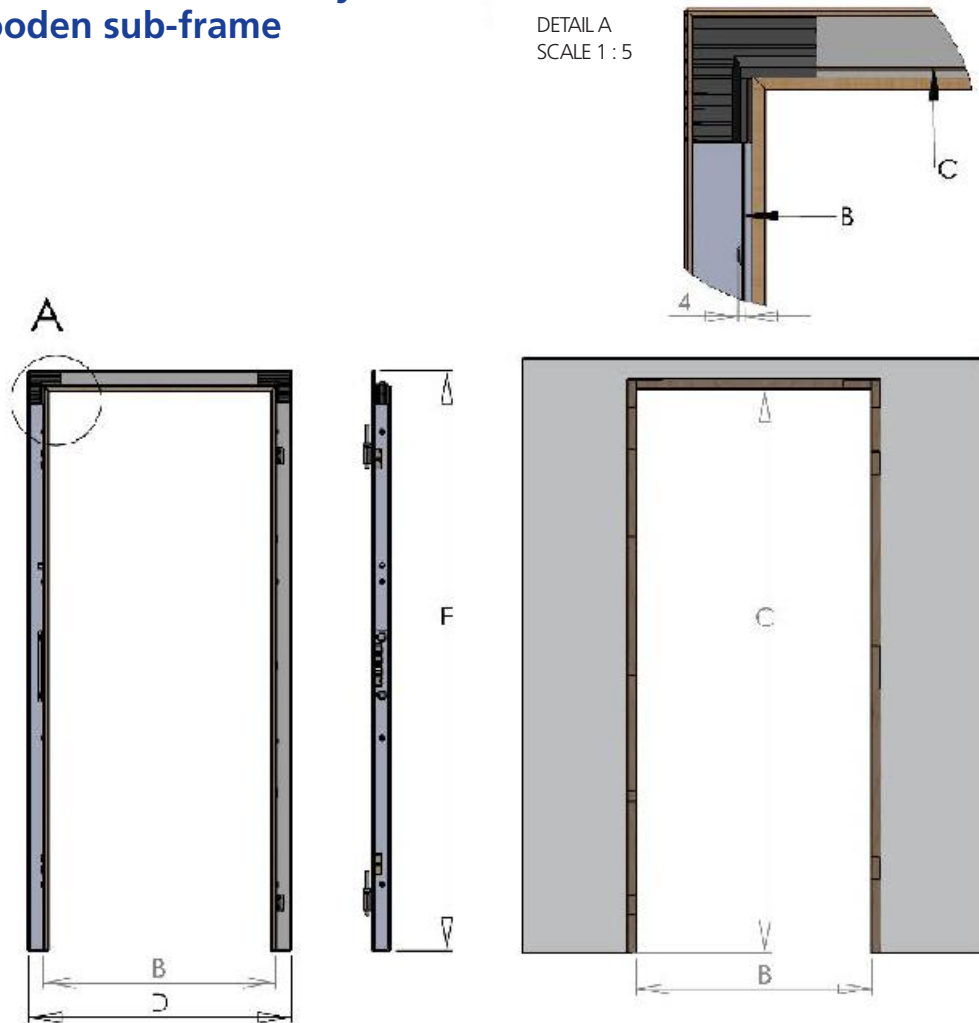

Armoured doorway opening	Wooden old sub-frame span's dimensions		Overall Dimensions / Internal Overlap	
	B	C	D	E
724 x 2014	765	2030	875	2085
804 x 2014	845	2030	955	2085
804 x 2034	845	2050	955	2105
904 x 2034	945	2050	1055	2105
804 x 2134	845	2150	955	2205
904 x 2134	945	2150	1055	2205
804 x 2434	845	2450	955	2205
904 x 2434	945	2450	1055	2205

This kind of assembly does not allow an optimal rear regulation of the door as it is the case with assembly on metallic sub-frame.





Door dimensions for assembly  
on metallic sub-frame.

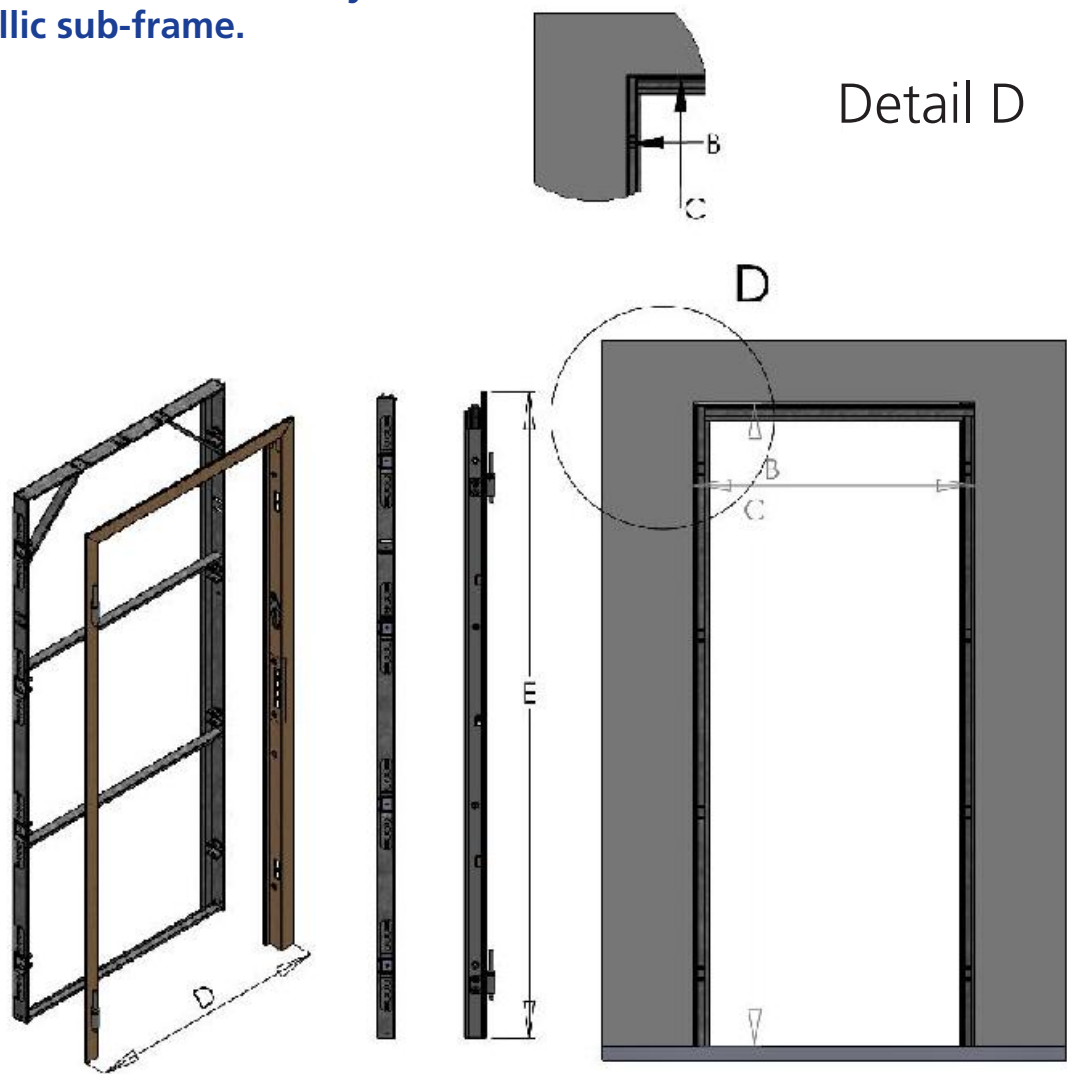

Armoured doorway opening	Wall sub-frame span's dimensions		Overall Dimensions / Internal Overlap	
	B	C	D	E
724 x 2014	836	2080	875	2085
804 x 2014	916	2080	955	2085
804 x 2034	916	2100	955	2105
904 x 2034	1016	2100	1055	2105
804 x 2134	916	2200	955	2205
904 x 2134	1016	2200	1055	2205
804 x 2434	916	2500	955	2205
904 x 2434	1016	2500	1055	2205





## Panelled decoration

The decoration of our Armoured Doors can be adapted at any time to the avant-garde designs since, even when placed in the building, the panels can be replaced easily without changing the door.

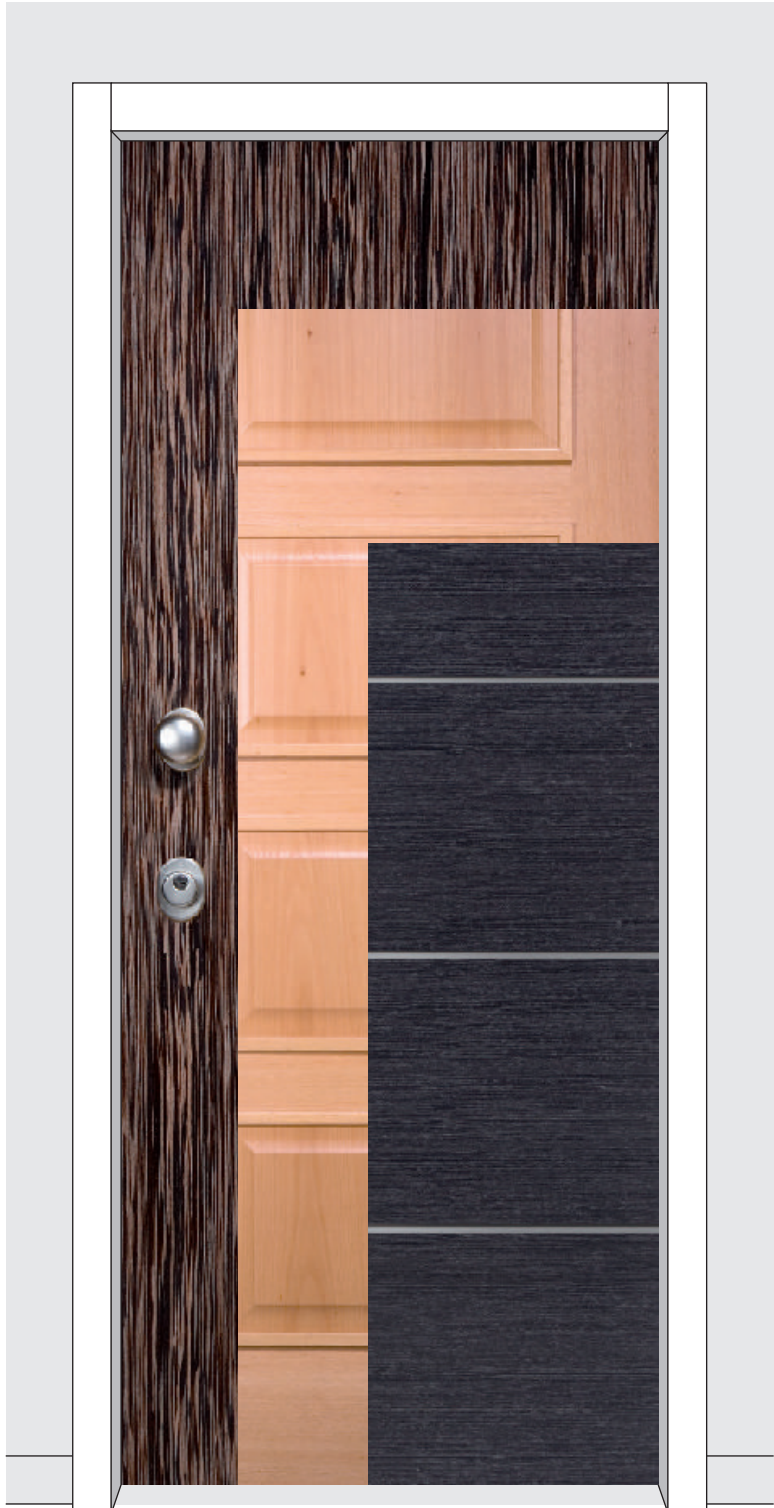

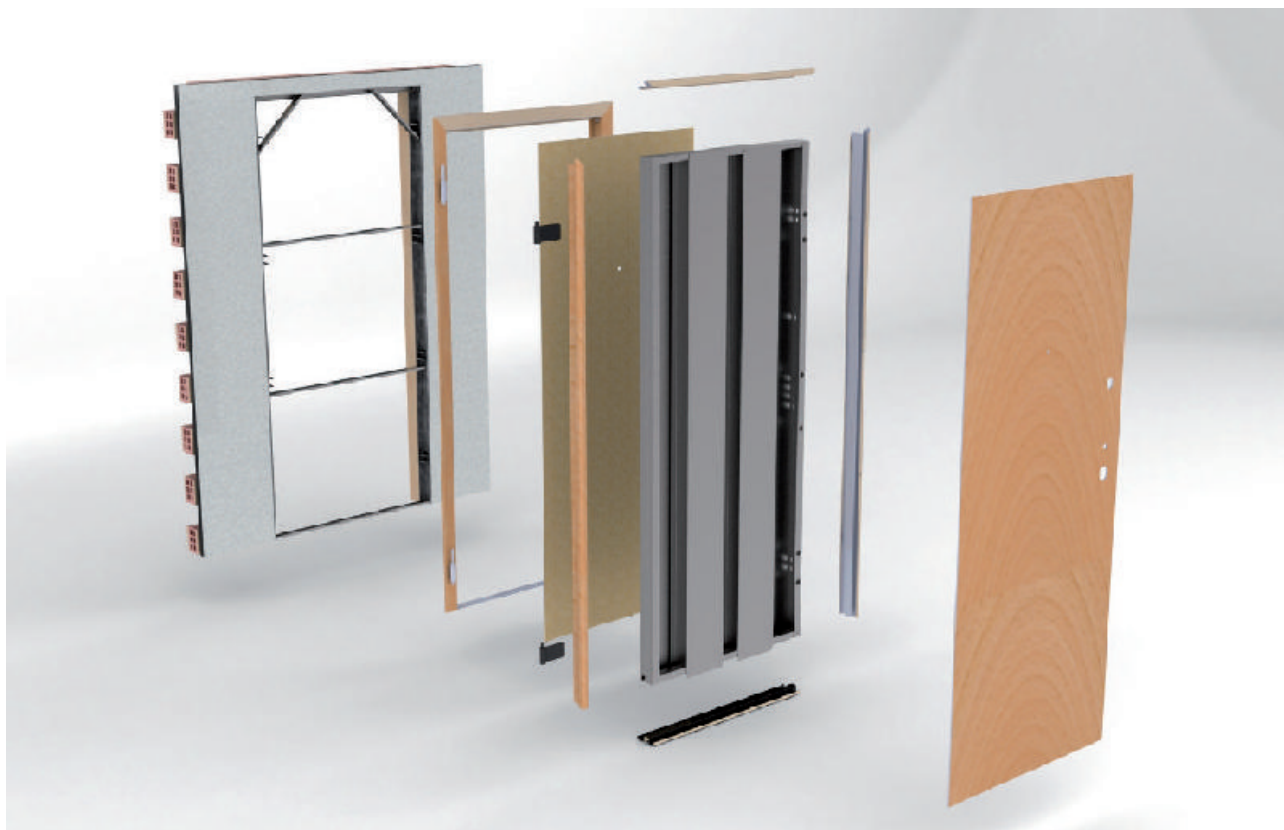

## Recommended selection of panels

Panels of 6 mm. of width

### Outside doors

#### Lacquered steel

Texture brown 4R  
Black sand 4R  
Lacquered white 4R

#### Wood imitation

Oak printing 4G  
Steamed beech 4G stainless  
Wenge 3GV stainless  
Plain Walnut

#### Lacquered fixed panels

Black sand 4R + Lat  
Black sand 4R + Sup  
Plain steamed beech + Lat  
Plain Wenge + Sup

### Symbios

Straight  
Curve  
Unequal

### Inside doors

#### Oak

Cross-banded oak 4G walnut  
Plain oak 2G walnut  
Straight oak walnut TR  
Banded straight oak  
Banded straight TR

#### Steamed beech wood

Cross-banded steamed beech 4R  
Banded plain steamed beech 2R

Steamed beech 54 H TR  
Steamed beech semiproven TR

#### Wenge

Wenge R7  
Wenge R5  
Cross-banded 4G stainless

#### Wood selection

Cross-banded ebony  
Red ebony  
Plain black elm  
Cross-banded black elm 4G stainless  
Plain Zebrano  
Cross-banded Zebrano + stainless

### Images







Outside doors

Lacquered steel

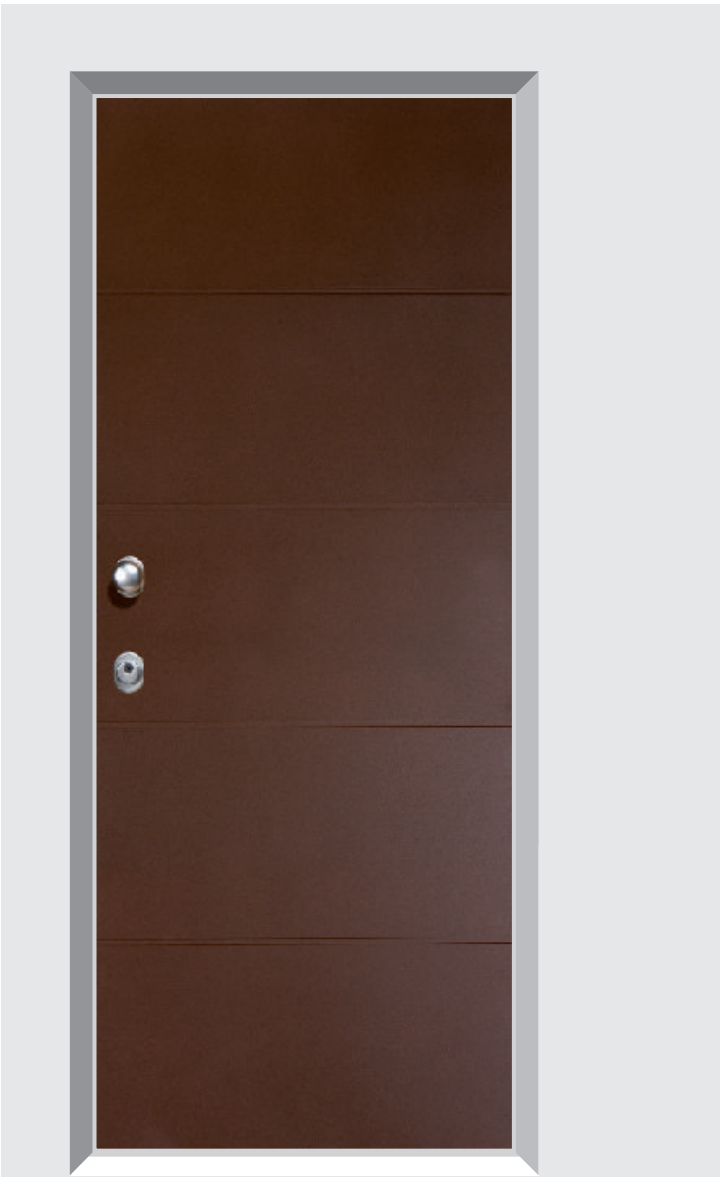

Texture brown 4R



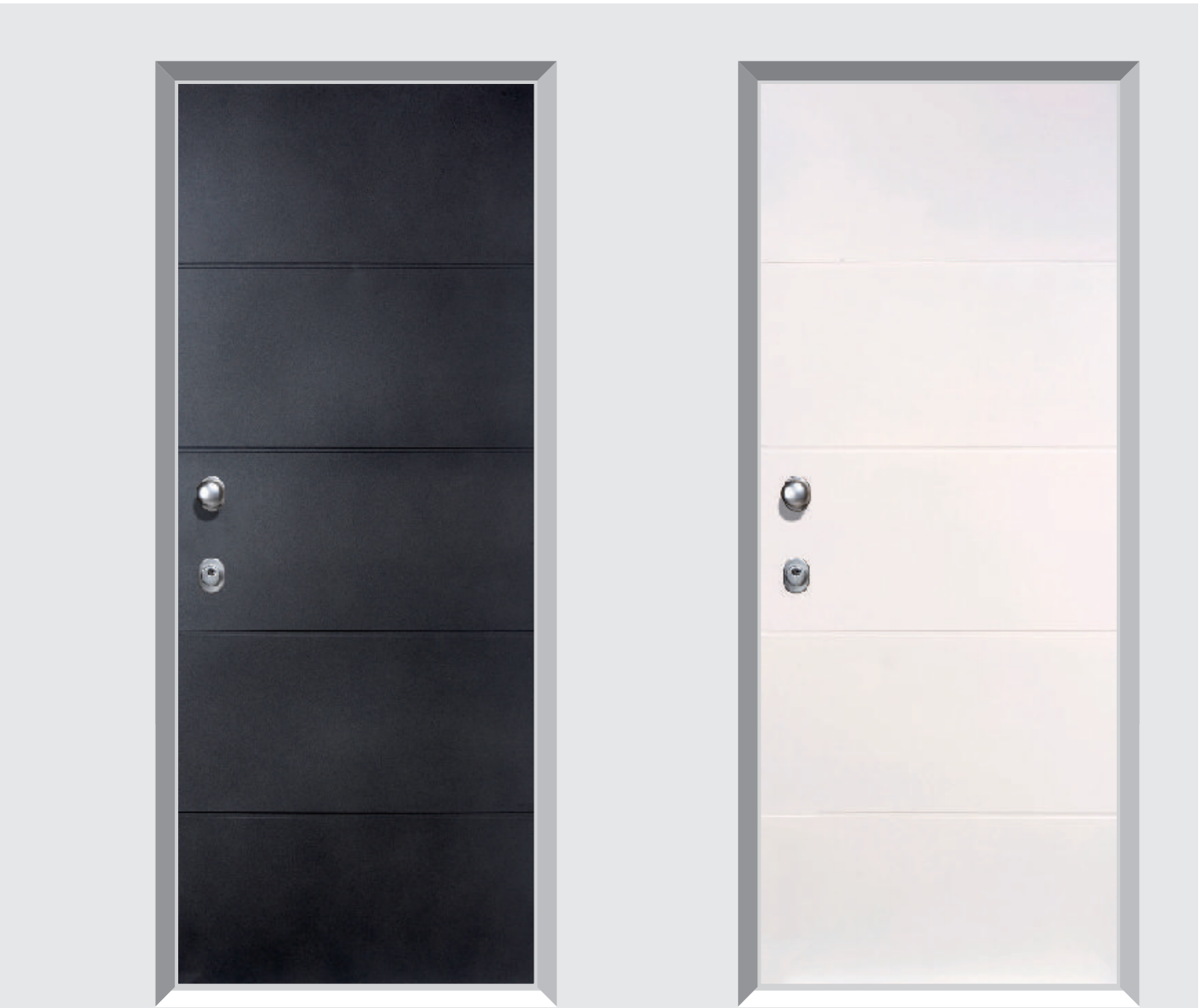

Black Sand 4R

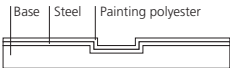

Lacquered White 4R

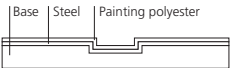



Outside doors

Wood imitation



Oak printing 4G

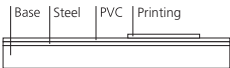

Steamed Beech 4G stainless

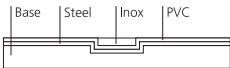



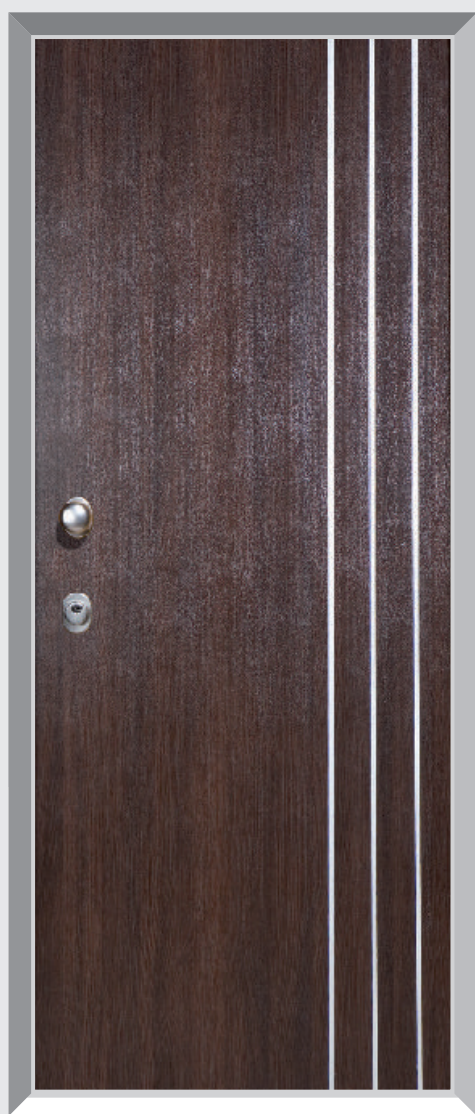

Wenge 3GV stainless

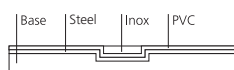

Plain walnut

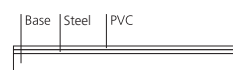

Outside doors

Lacquered fixed panels



Black Sand 4R + Lat

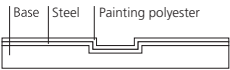

Black Sand 4R + Top

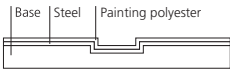

Fixed panels - wood imitation



Plain steamed beech + Lat

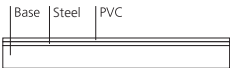

Wengé Plane + Sup

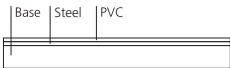

## Outside doors

### Symbios

The exclusive collection Symbios represents an innovation in the decoration of armoured doors, combining the resistance of steel with the elegance of wood. These materials are blended thanks to the available drawings allowing this finishing to be a high level and good taste choice.

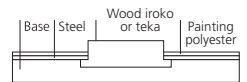

Straight



Curve



Unequal







Inside doors

Oakwood



Cross- banded oak 4G Walnut

Base	Natural Wood	Natural Wood
------	--------------	--------------

Chêne Plane 2G Noyer

Base	Natural Wood	Natural Wood
------	--------------	--------------

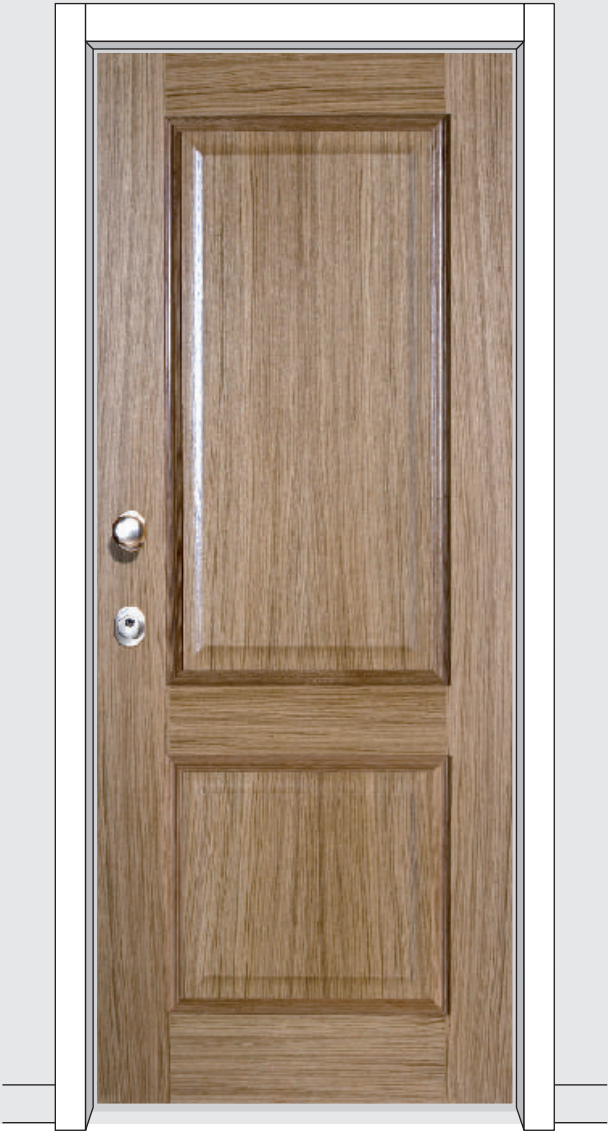

Straight Banded Oak TR



Straight Banded Oak

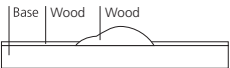

Inside doors

Steamed Beech

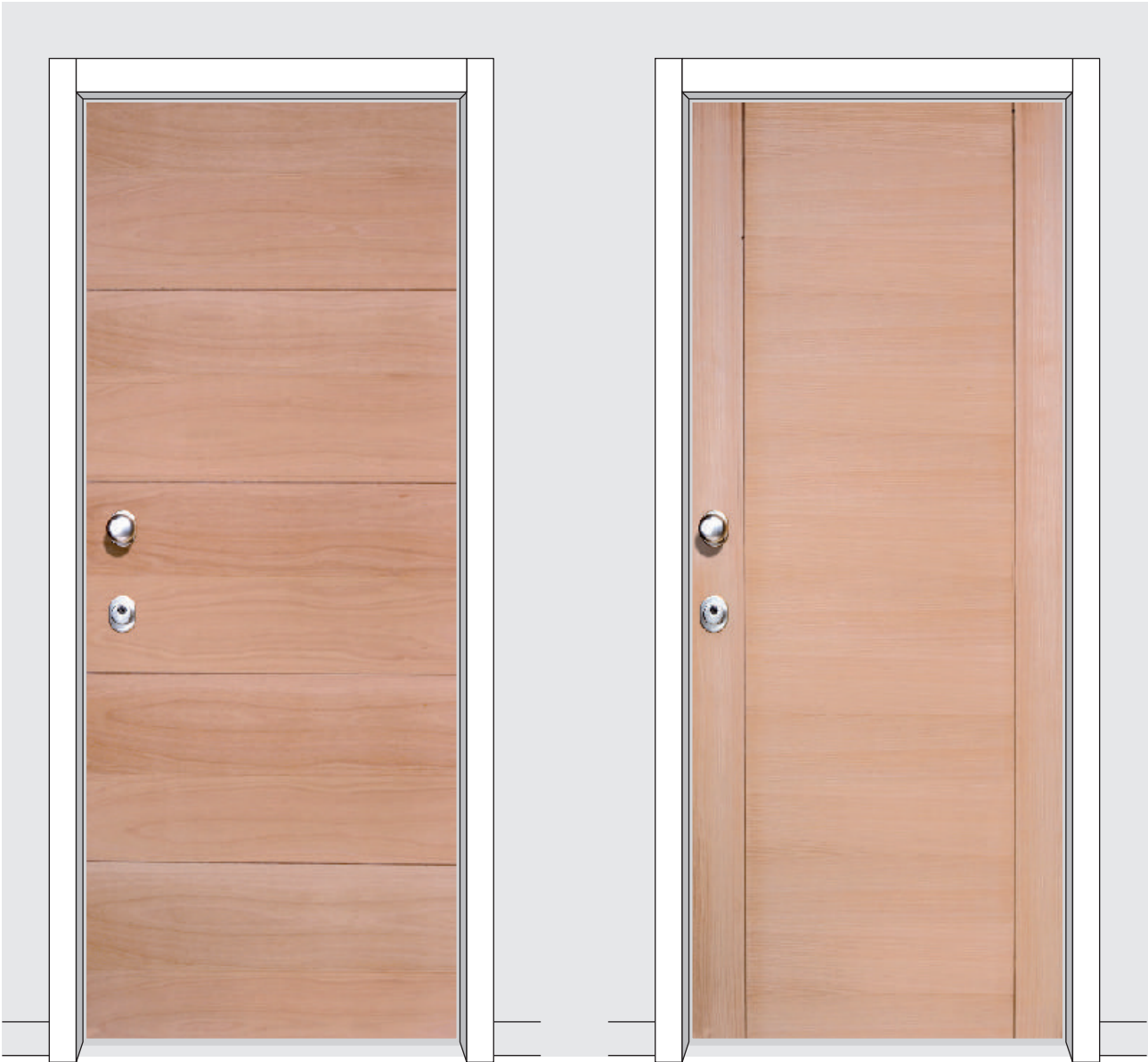

Cross-banded steamed beech 4R

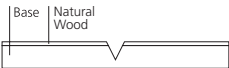

Plain banded steamed beech 2R

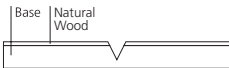

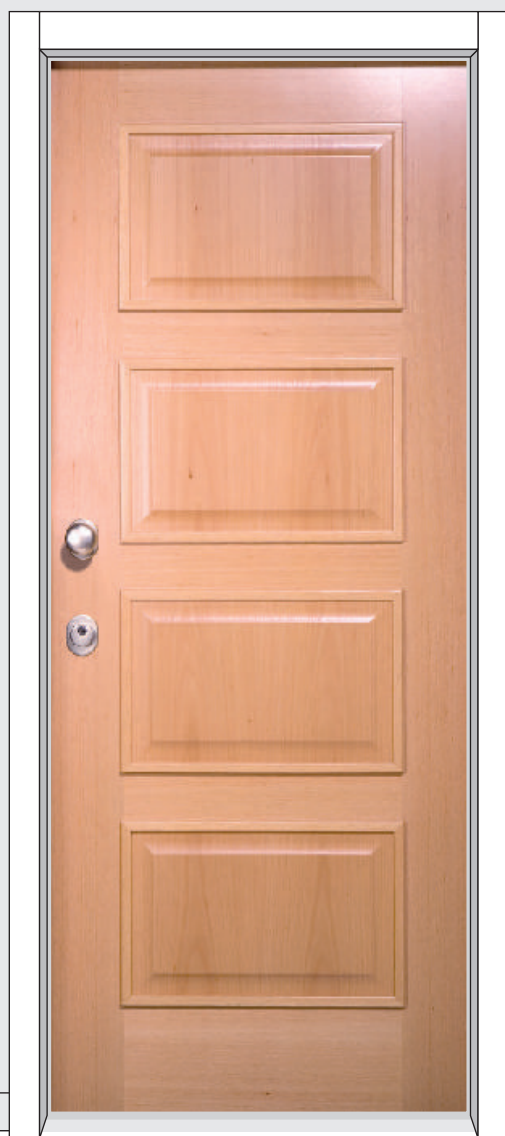

Steamed beech 54 H TR

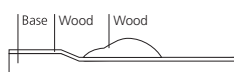

Steamed beech Semiprovence TR

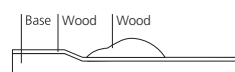

Inside doors

Wenge

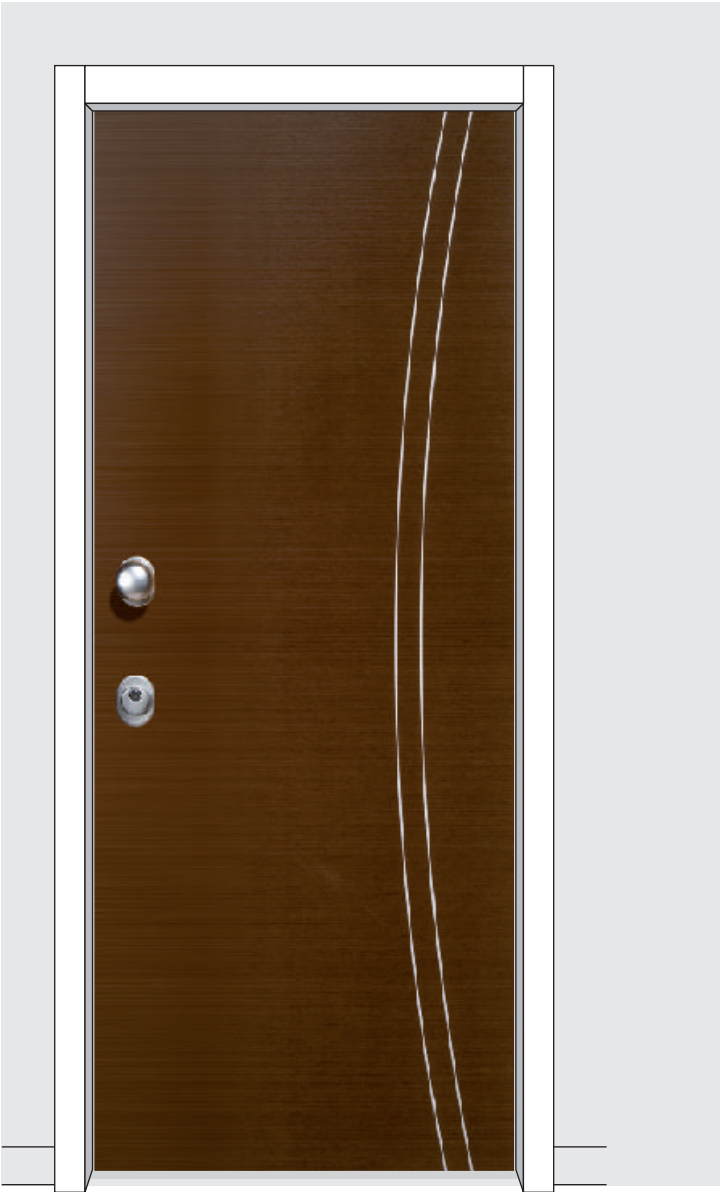

Wenge R7

Base	Wood	Stainless



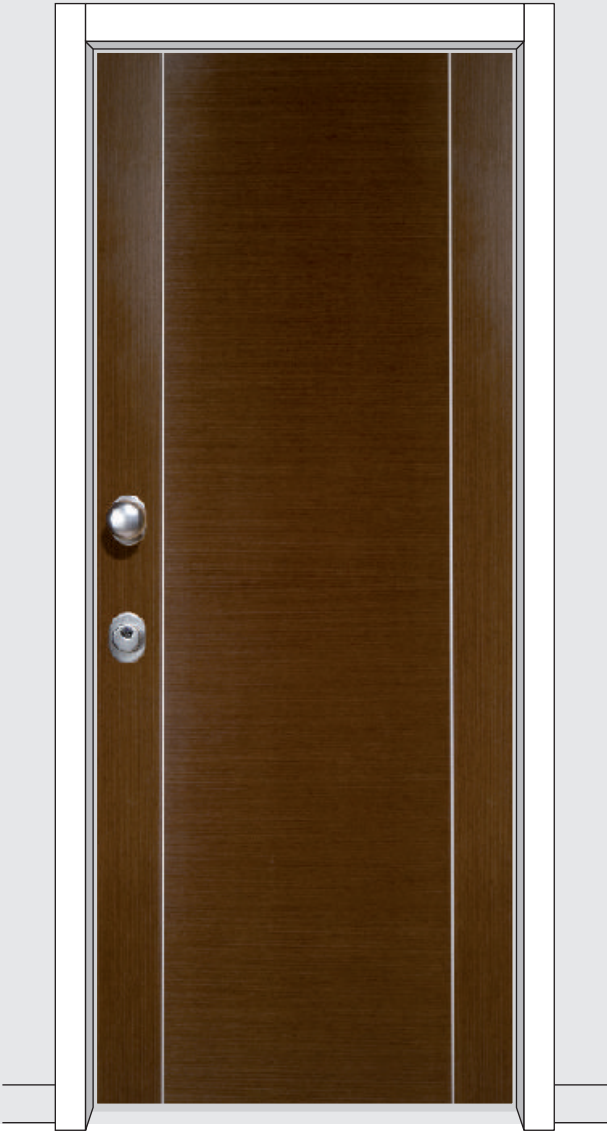

Wenge R5

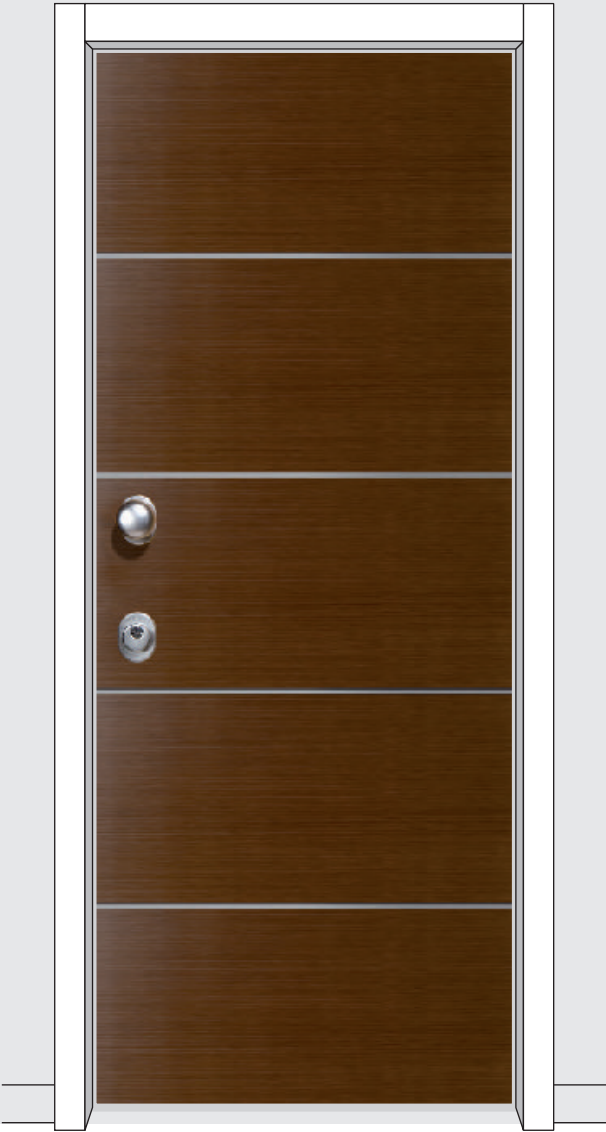
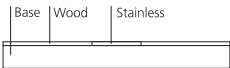

Cross-banded 4G stainless

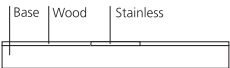









Inside doors

Wood selection



Cross-banded ebony



Red ebony





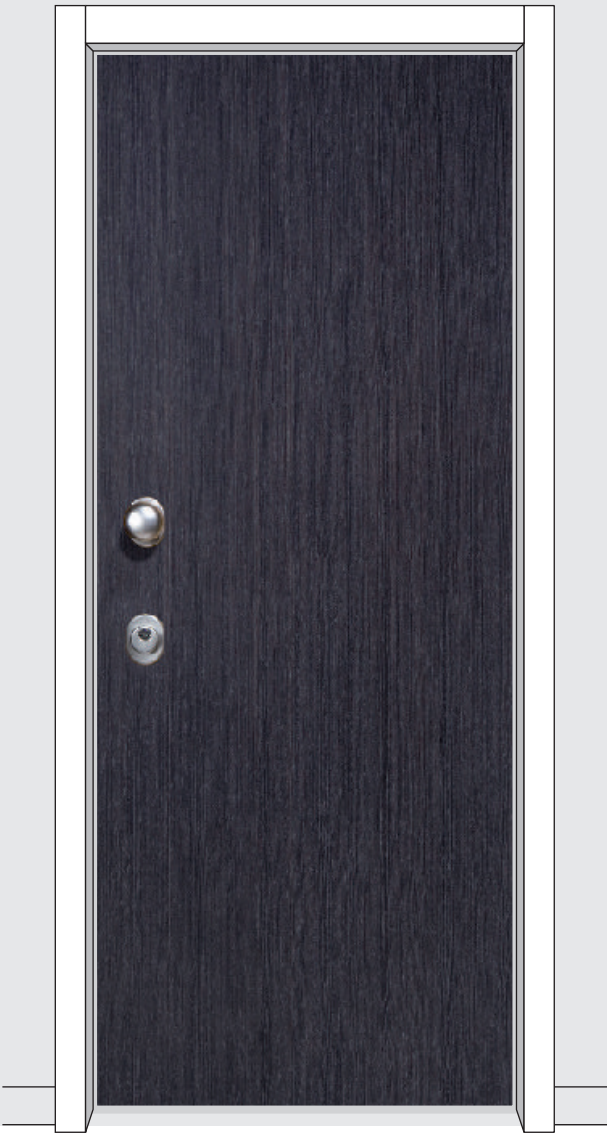

Plain Black Elm

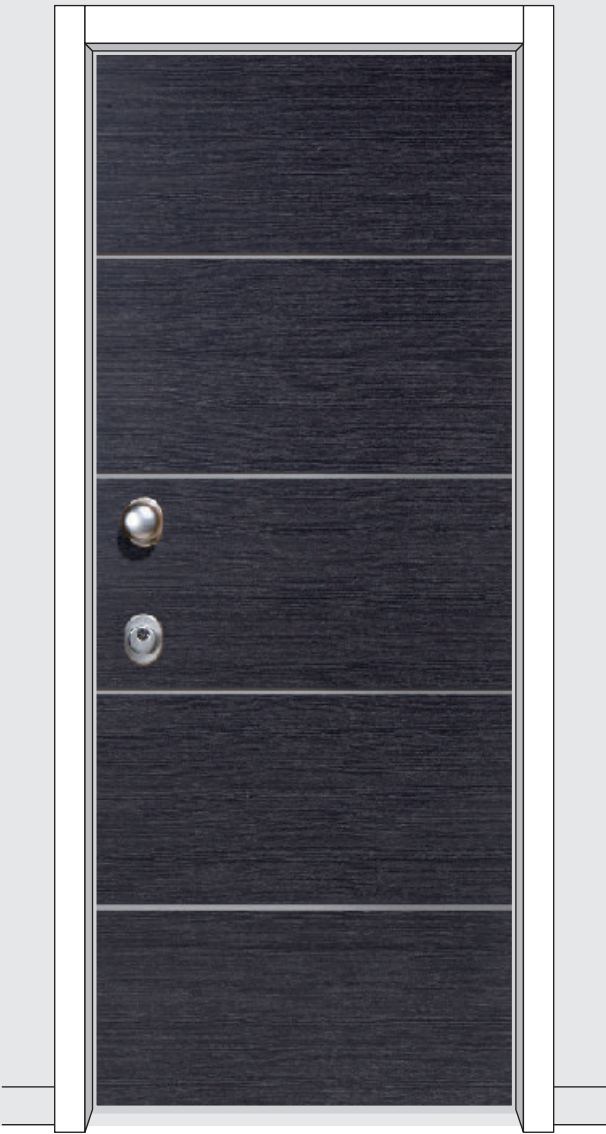

Plain Black Elm 4G stainless

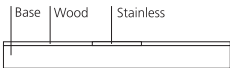

Inside doors

Wood selection



Plain Zebrano



Cross-banded Zebrano  
+ Stainless steel

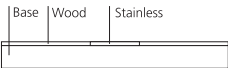

Images

Any type of image or drawing can be printed on panels. The client shall obtain the agreement of the rights' owner for the images or drawing which he/she intends to use. Parents' agreement is required in case of pictures of minors.

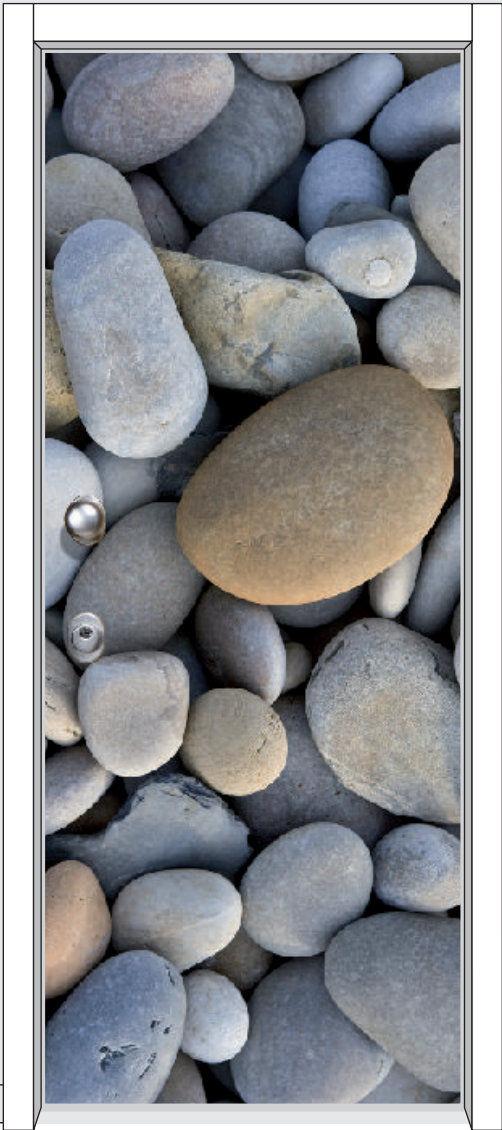

Base	Vinyl	Printing

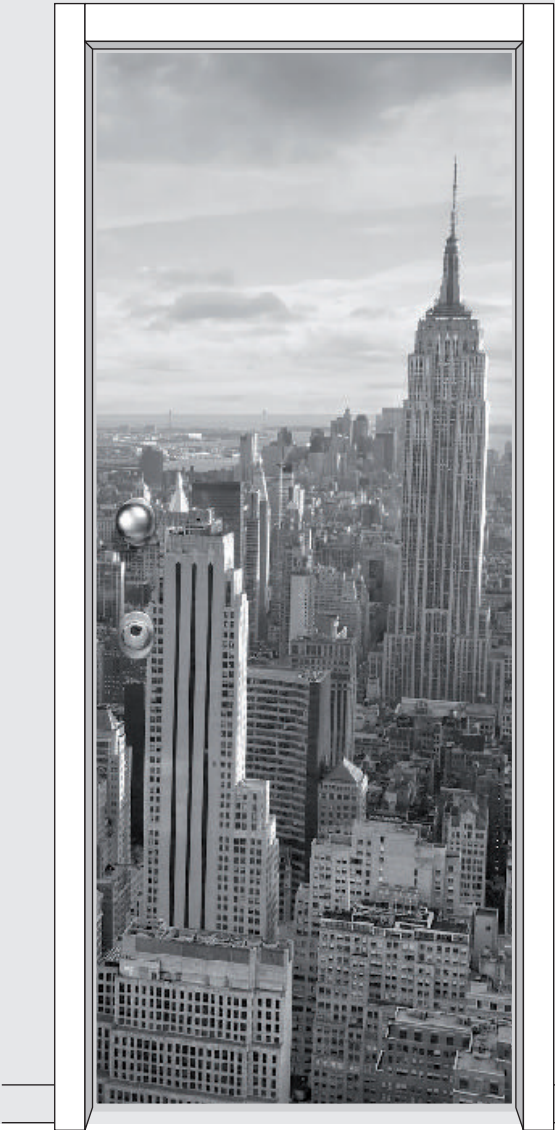

Base	Vinyl	Printing



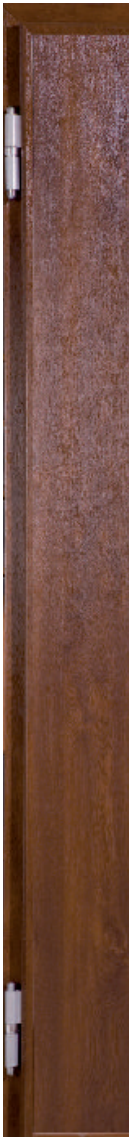















## Door handles

Including handle, door handle and peephole. Handle, peephole and safety latch are always machined unless otherwise specified.



Gold matte

Bronze Matte

Nickel Matte





## Opening and locking system. Access control



App D-Smart

Automated security is what we can offer to our clients if they want or require it, as it is the case with reduced mobility users.

We can install optional features on the Armoured Door, i.e. motorized and/ or electronic security systems, active TAG opening systems, display panels with TFT screens, to meet the most demanding needs of the market in the field of automated security. The optional feature, consisting of a 5,7" display panel with outside panoramic camera, allows clients to obtain a video signal to be observed, stored or sent to other devices in every part of the world, i.e. by means of an MMS. This last option is not available in the standard model of the TFT displaycamera, yet.

### CHARACTERISTICS:

- Recording photos and video.
- Button integrated into the camera.
- Function of missed calls.
- Infrarouges to see the picture in total darkness.
- By pressing the button of the bell, you send a message to call your smartphone or your
- Tablet. Thanks to the application, you can see, hear and talk from your mobile device.
- The application will allow you to access from anywhere for see and hear what's going on in the input environment to your home.
- Can be paired to a maximum of eight users.
- If you can not answer to an external call, you can activate the DND (do not disturb / do not disturb), then display the visitor information.
- Emergency call: if you are in emergency situation, by supporting on a button, all users will receive an alert message.
- Low consumption: it can be in
- Standby mode for more than three months.

The position of the TFT screen in the back part of the door depends on the choice of the end user, who can decide to include it or not, depending on his/ her specific needs, e.g. the system can prove useful for people using wheelchairs.

D-SMART is the new device lock automation

European cylinders (key center 85 mm).

The scheme applies to all European cylinders with a diameter of 8 mm.

Easy to install, with connection to power grid or power supply to drums. Bluetooth secure technology and encrypted.

Opening the door:

Smartphone: download the application D-SMART from Apple systems, Android and Windows Phone to manage access and configure the door.

Numeric keypad: a code customizable for each user manageable with time bands.

(OPTIONAL)

Transponder: electronic key format Keychain with Q5 technology.

(OPTIONAL)

Remote control: for opening proximity.

(OPTIONAL)

Controls and restricts access authorized users at the entrance.

Another option is the motorized locking system, which is similar to the already known mechanical one.

Like the latter, it can be operated mechanically, and/or electronically, by means of a built-in motor.

One of the main advantages as far as security is concerned, on top of being manifestly comfortable, is the fact that each time that the door closes up, when stepping in or out of the house, the locking device is activated to completely close the door as soon as

the locking screws turn completely. No more doubts about whether the door is completely locked or not, thus ensuring complete trustworthiness and security. This function, similarly to other ones, can be programmed from the control of the locking device.

Together with the motorized locking system, we provide the electronic keys (transponders), one of which must be programmed as the main one to be entered into the programming module, e.g. among the many available options, creating or cancelling new users. In the download area of this Web page, you can download the full user's manual of the motorized locking system.

As an alternative to the motorized locking system – although an altogether different product – we also offer electromagnetic door opening systems, allowing opening the door only from the position of the latch at the level of the service door.

Alternatively, we can offer our clients a system providing the opening of the door, both at the level of the locking device, and at the level of the abating leaf. It is possible to obtain this system by combining the motorized locking device with the motorized door leaf. Both devices can be programmed and are suited to work simultaneously.

By means of a signal, it is possible to activate the door leaf and open it with unrivalled firmness and quietness. The latter is completely programmable and is equipped with security sensors in order to avoid entrapments.

Such signal may come from the motorized locking system by activating opening functions, or from radiofrequency devices, such as TAG systems and/or presence detecting devices, tracking down presences and the intention to open

a door. All these signals can be programmed, modulate and adapted to the circumstances and specificities of each situation. This last option is offered to reduced mobility users to allow them to feel secure, comfortable, as well as to provide them with a stylish solution for their houses' doors. See the news section to obtain further information about reduced mobility users.



LCD screen with camera viewfinder



Fingerprint device



Outside automatic door leaf, suited for reduced mobility people"



Packaging











**ACORÉ VAL**

Calle de Emilia Pardo Bazán, 38  
Polígono Industrial els Mollons  
46970 Alaquàs  
Valencia. Espagne  
Tel. +34 961 503 407  
Fax +34 961 500 740  
[info@acoraval.com](mailto:info@acoraval.com)  
[www.acoraval.com](http://www.acoraval.com)

