

[www.securemme.it](http://www.securemme.it)

# D-SMART

Make your lock motorized



EN

Pat Pending

 **SECUREMME**  
SERRATURE DI SICUREZZA

Made in Italy  



# INDEX

<b>Package content</b>	4
<b>Description</b>	5
<b>Technical features</b>	6
<b>Warnings</b>	7
<b>Installation</b>	8
<b>Installer set</b>	10
<b>Owner configuration</b>	13
<b>Power Grid Schedule</b>	18
<b>Warranty conditions</b>	19
<b>Paper template</b>	21



# PACKAGE CONTENT

- |     |   |              |
|-----|---|--------------|
| (1) | CIRCUIT BOARD (cod. PL8000KxxSH) + MOTOR (cod. MR8000KZA7038) | <u>1 pz.</u> |
| (2) | SUPPORT BATTERY PLATE (cod. PK8000KxxCT)                      | <u>1 pz.</u> |
| (3) | HANDLE (cod. 5000Xxx)   | <u>1 pz.</u> |
| (4) | KNOB FOR CYLINDER (cod. 5032Xxx)                              | <u>1 pz.</u> |
| (5) | FIXING SCREW FOR SUPPORT BATTERY PLATE (cod. VT80M3XZB25XX)   | <u>3 pz.</u> |
| (6) | RECHARGEABLE BATTERY (cod. PP8000KxxXXBT)                     | <u>1 pz.</u> |
| (7) | CHARGER (cod. PP8000KxxXXBT)                                  | <u>1 pz.</u> |
| (8) | ADHESIVE MAGNET (cod. MG8000XXXXXPO)                          | <u>1 pz.</u> |

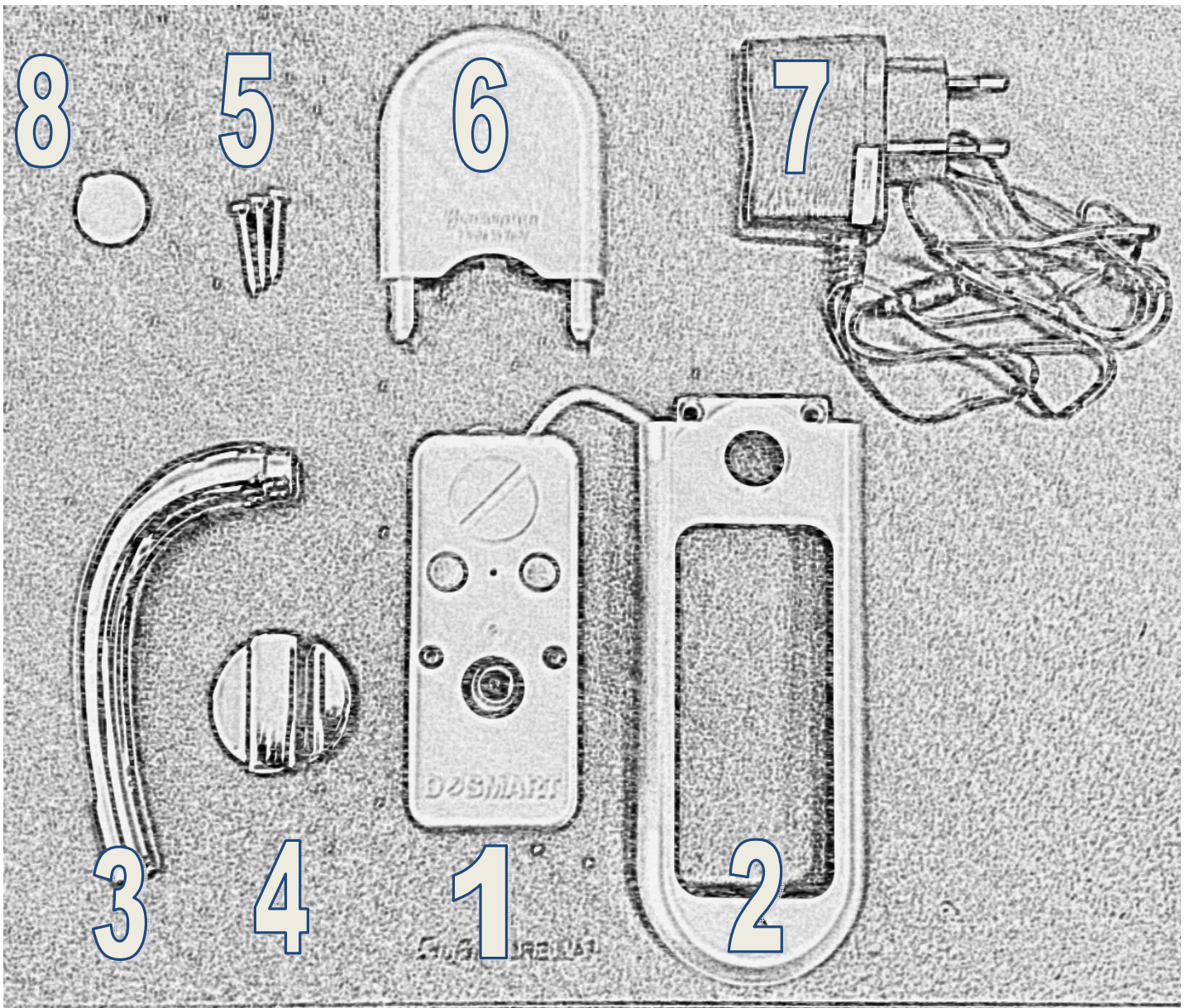

**D-SMART**

Make your lock motorized



# D-SMART DESCRIPTION

DSMART is the new device used to motorize locks with European cylinder (interspace handle—key center 85 mm).

The device can be installed on every European cylinder with an 8 mm diameter removable knob.

Easy to install, it doesn't require any connection with mains, supply or battery.

Safe and encrypted Bluetooth technology.

Opening of the door with :

Smartphone: download the D-SMART application from the Apple, Android and Windows Phone stores to manage the access and to configure the door.

Numeric keypad: customizable code for every user with time slots. (OPTIONAL)

Transponder: key ring format electronic key with Q5 technology. (OPTIONAL)

Remote: for an opening near the door. (OPTIONAL)

Check and limit the access of the users previously enabled.

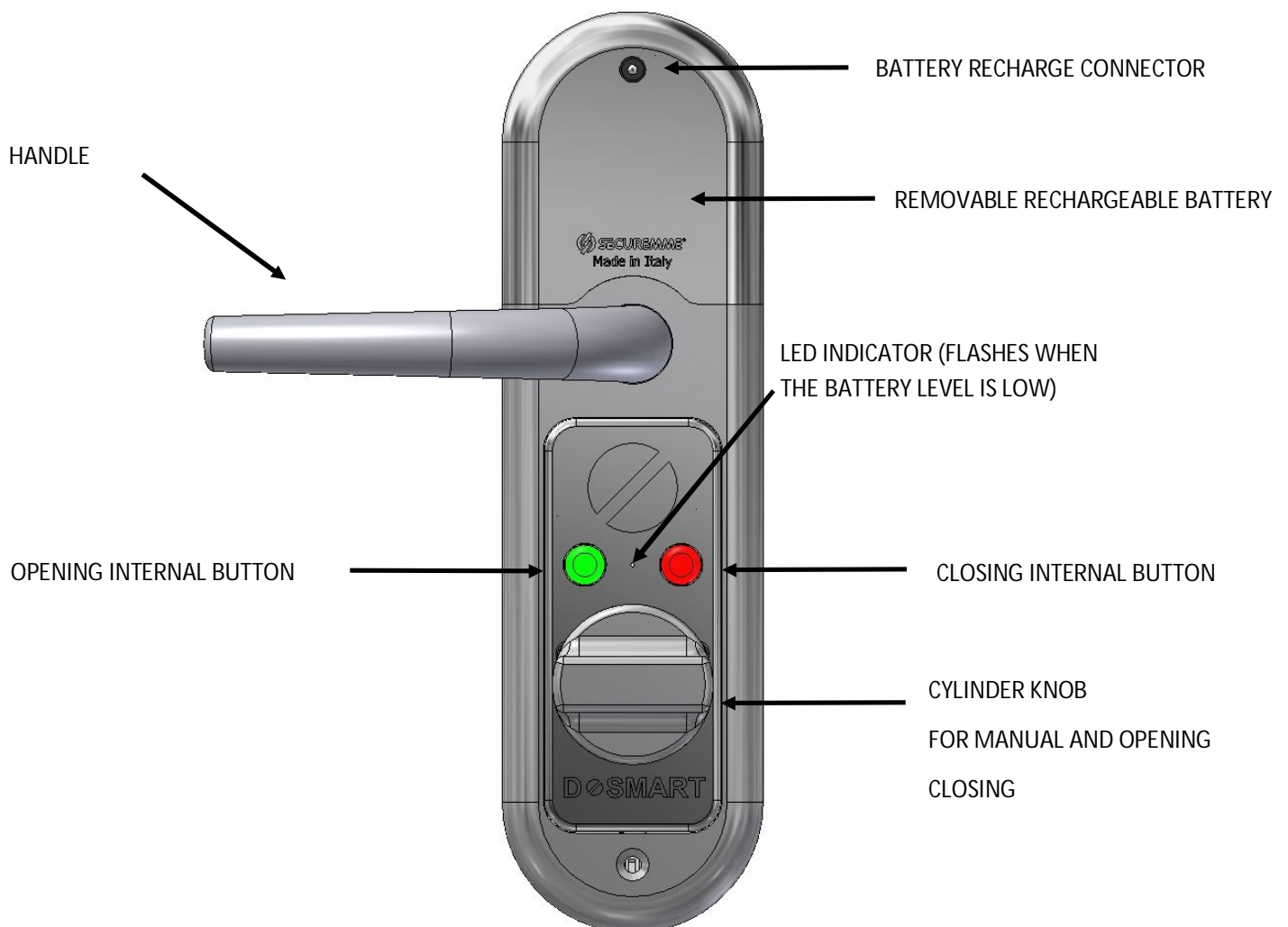

# D-SMART TECHNICAL FEATURES

**Dimensions:** 230 mm x 65 mm x 25 mm.

**Circuit board:** Bluetooth technology BT (4.1).

**Communication frequency:** 2.4 GHz.

**Battery type :** Lithium ion rechargeable battery (Li-Ion).

**Battery features:** 3.7 V , 3700mAh (**use only Securemme battery and charger**).

**Supply features :** input AC 100 - 240 VAC ; output 4.2 VDC,1 A ; 50-60Hz.

**Battery recharge time:** around 6 hours.

**Operatine temperature :** -10°C ~ +45°C.

**Estimated lifetime :** around 3 months (theoretical calculation on 10 openings per day).

**Supported systems :** ios 8 or later versions; Android 4.4 or later versions; Windows Phone 10 or later versions.

**Connectors description:** 1 = supply connector; 2 = motor connector; 3 = external number keypad connector.

**Internal keypad:** opening by pressing 0 (system ignition) + code, closing by pressing 0 (system ignition) + R.

**Security:** after 3 wrong or improper opening attemps the device is blocked for 10 minutes.

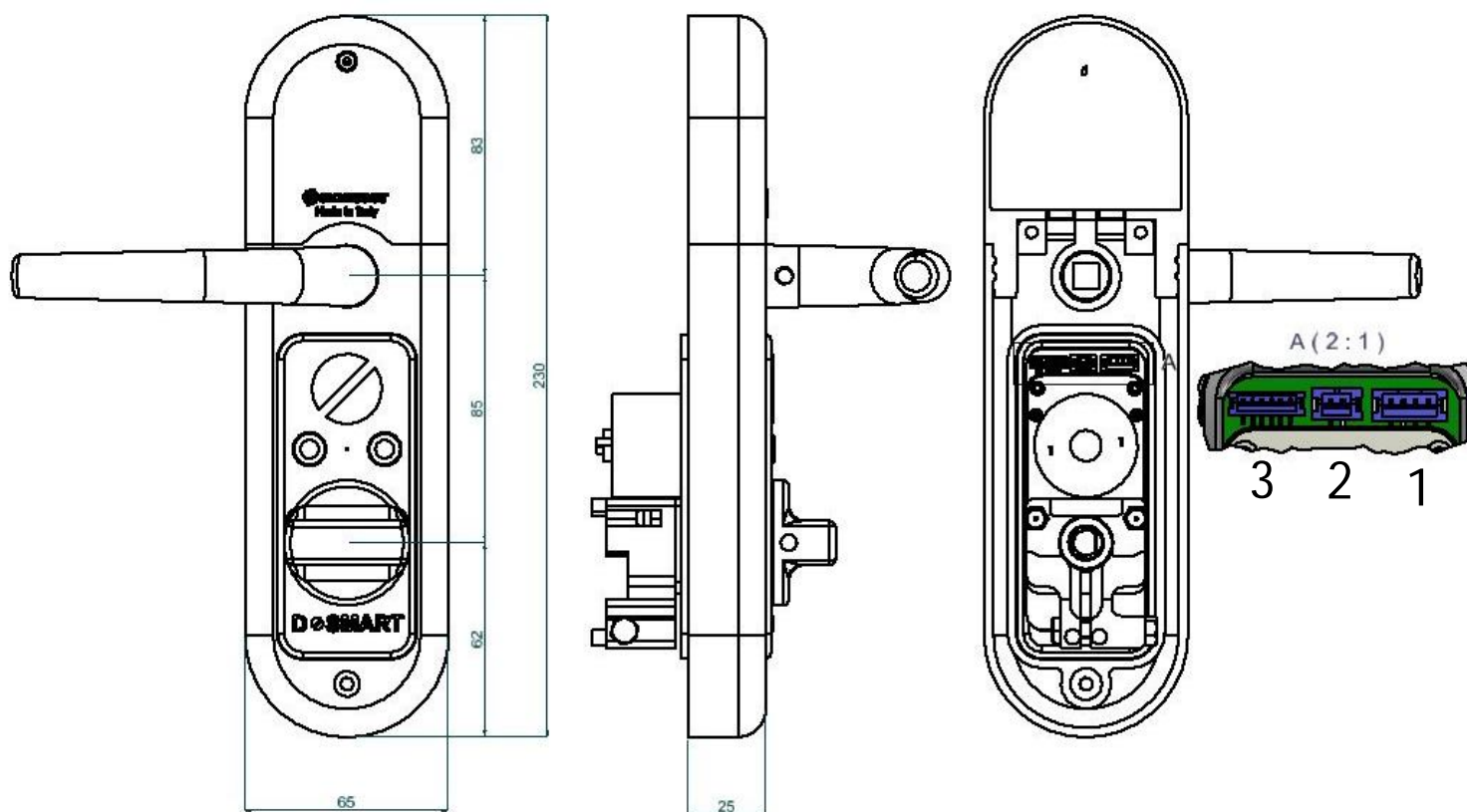

**D-SMART**

Make your lock motorized

# D-SMART WARNINGS

- Failing to comply what is written in this instructions manual, may affect the proper functioning and the subsequent lost of the warranty.
- Any other use is to be considered improper or dangerous.
- Do not reverse the polarity of the metallic contacts on the plate and/or the battery.
- Do not make any working on the door with the device installed, in order to avoid wood or metal traces that can infiltrate in it.
- Handle with care the battery .
- The device can be used for the purpose it was designed for, that is with Securemme battery and charger .
- Movement of the motor electronically controlled .
- The connection of all the links must be performed in compliance with the existing rules.
- Before performing any maintenance on the product, disconnect the battery.
- In case of failure and/or malfunctioning of the product remove the battery and use the mechanical key.
- For any service, contact only Securemme or an authorized assistance center previously authorized by Securemme .
- Securemme S.r.l. reserves the right to make any changes to the product and to the user's manual it deems appropriate, in order to improve the quality or for production and commercial needs.

## **DISPOSAL**

- The product can not be disposed among the household waste. At the end of the cycle of its life, dispose the product according to the current regulations.
- Rechargeable battery : as final user you have the obligation (according to the Battery Regulation) of returning all the rechargeable batteries that were used before ; the disposal among the household waste is forbidden. The contaminated rechargeable batteries are labeled with a special symbol that indicates that cannot be disposed among the household waste. The designations for involved heavy metals are: Cd = Cadmium, Hg = Mercury, Pb = Lead (the designations can be found on the rechargeable battery, as instance under the waste bin symbol reported on the left). It is possible to freely take all the used batteries to a local authorized disposal center. In these ways all the legal dispositions are followed and you contribute to the environmental protection.



# D-SMART INSTALLATION

Before you proceed, fully recharge the battery (until the led on the charger becomes green).

1. Make a cut in the inner panel as shown in fig. 1, having dimensions of 50 x 105 mm, to housing the motor unit. Cut out the paper template available on page 18 and place it on the inner door panel. On the external panel prepare a 20 mm hole only if you have the external numeric keypad—transponder reader, insert the cable from the external side to the internal cut and connect the cable to the circuit board in position 3 (see page 6).
2. Use a cylinder with knob predisposition ( preferably a Securemme one) and make sure that the size is correct.
3. For a correct operation of the product, the lubrication of the stem in the rotation area is recommended.
4. Install the cylinder on the lock and fix it.

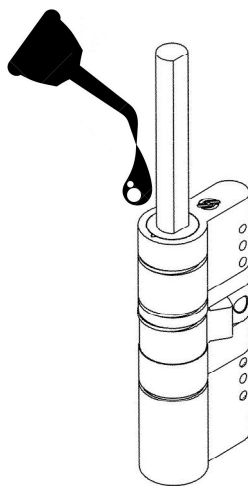
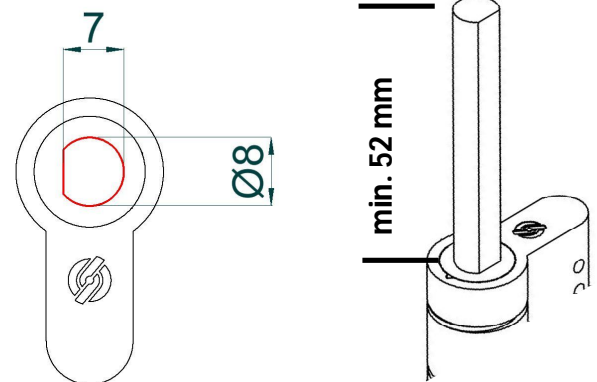
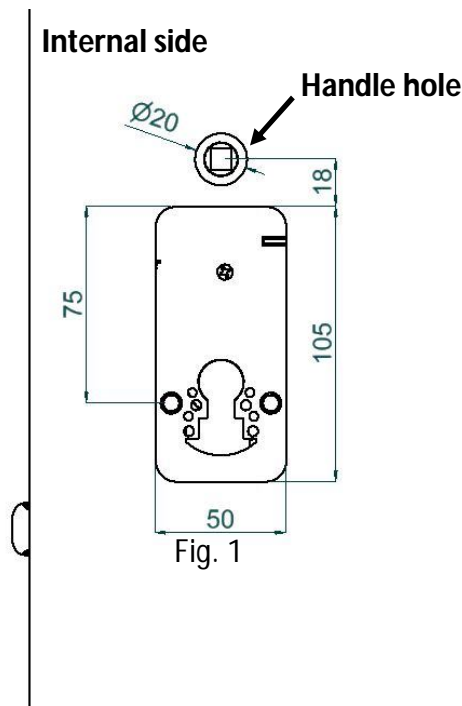

Fig. 3

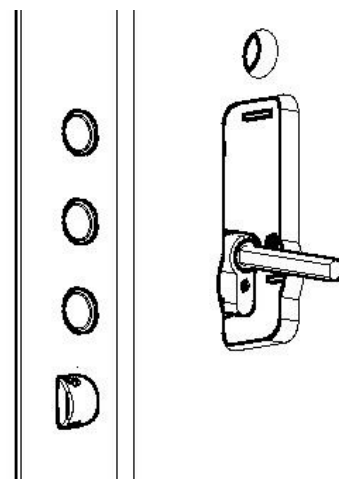

Fig. 4

**D-SMART**

Make your lock motorized

# D-SMART INSTALLATION

5. Install the housing motor on the stem of the cylinder until it stops, ensuring the alignment of the flat surface of the stem with the housing motor.
6. Fix the housing motor by tightening the screw with a 8mm hex wrench.
7. Place the battery support plate on the panel.
8. Install and thighten the handle and the knob on the cylinder
6. Fix on the panel the battery support plate with the 3 screws provided.
7. Insert the battery until is stops and try to make the first test, by pressing the opening and closing buttons.

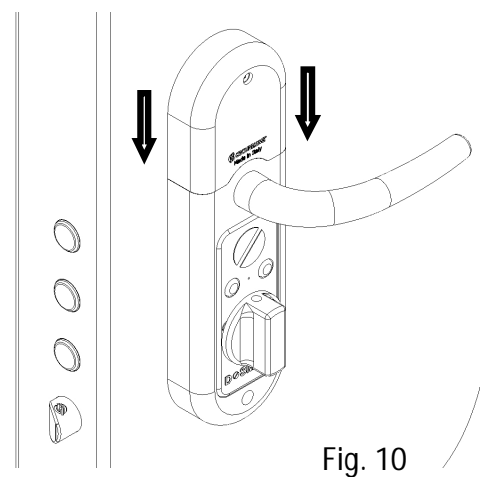
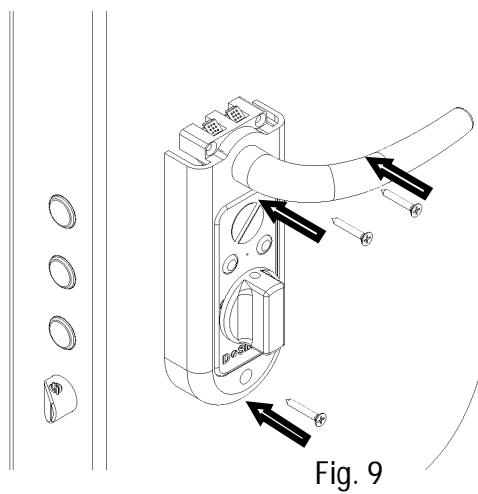
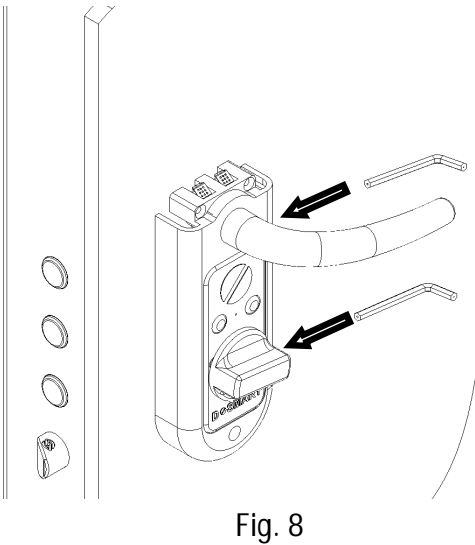
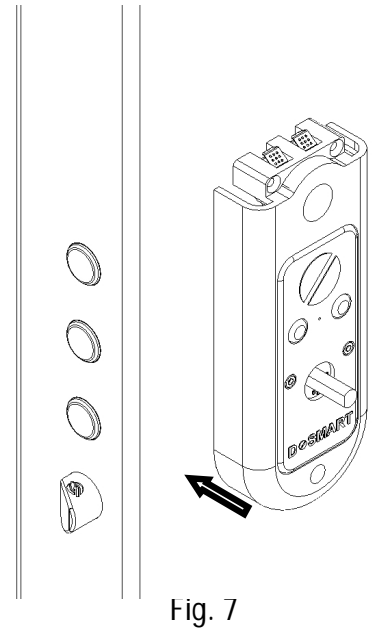
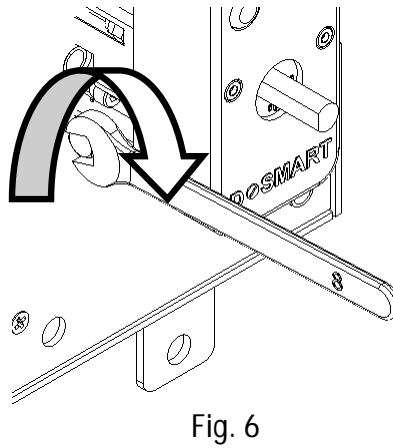
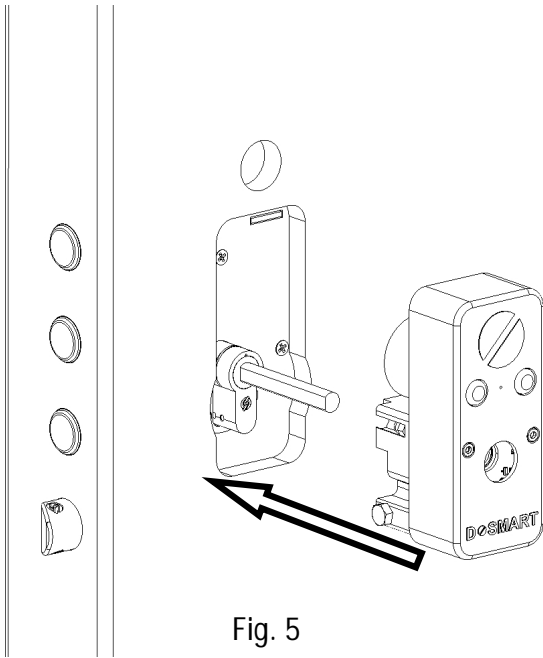



# D-SMART CONFIGURATION Installer

11. Turn the smartphone bluetooth on and scan for new devices.
12. Connect it with the device having the default name **Securemme**.
13. Download the specific smartphone application by typing Dsmart or Securemme into the IOs, Android and Windows Phone store, then open it.
14. Add a new device by clicking on + **(Add lock)**
15. Click on *Scan* to find the Securemme device with its relative address.
16. Click on *Securemme* and connect the device with the smartphone.
17. Click on the logo settings to get access to the lock detail.
18. Click on *date and time* and save to synchronize the time with the device.
19. Insert the Factory master code: **master**.
20. Click on *Advanced options* for the configuration of the door.
21. Set the motor power: the power is set on a standard default value, it is possible to increase this value of 15% in case of more friction. Please note that an increase of the power corresponds to an increase of the battery drain.
22. Closing mode: *Manual*= closing of the lock even with door opened (without magnet); *Semiautomatic*= closing of the lock by clicking on the red button only with door closed (it is necessary to affix the magnet); *Automatic* = closing of the lock everytime the door is closed (it is necessary to affix the magnet).
23. *Closing sensor*: use the default magnetometer (affix the magnet on the door frame).
24. *Opening direction*: set right or left according to the door orientation.
25. *Calibrate magnetometer*: do this operation with "closing mode"=manual. Apply the magnet on the frame without sticking it, but by placing it in the middle of the frame in-line with the handle (see Fig 11); close the door and click on the command "Calibrate" when the door is closed. Remember to check that the acquired data with closed door should be higher than 300 points over the value acquired when the door is slightly away from the swing door. Otherwise replace the magnet and repeat the operation. Now is possible to set the semi-automatic or automatic closure.



# D-SMART CONFIGURATION Installer

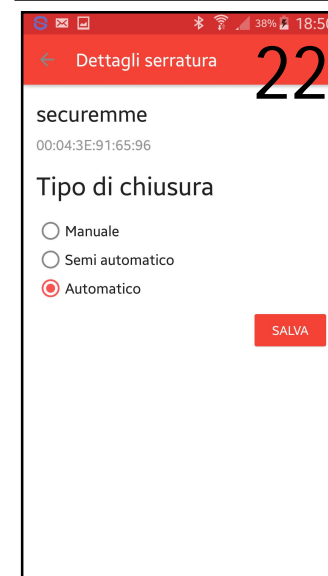
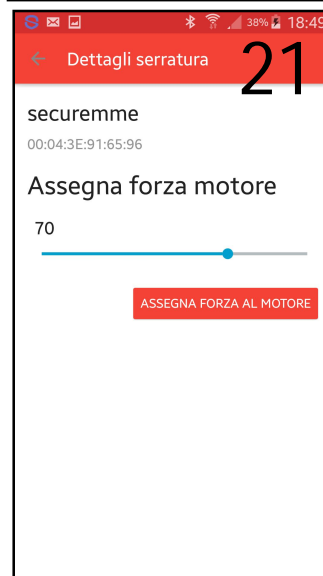
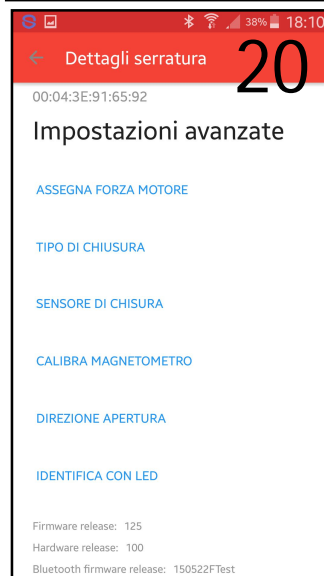
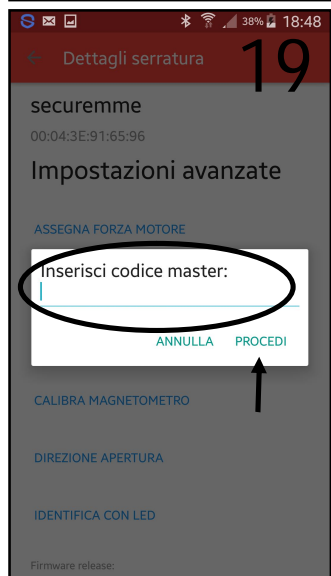
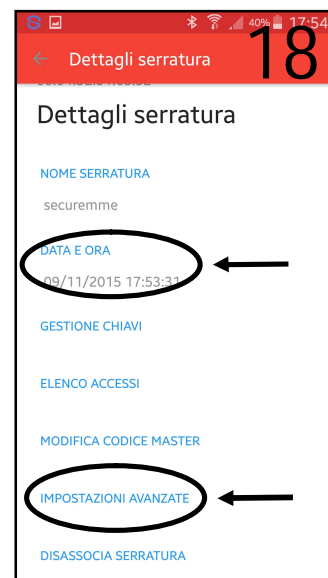
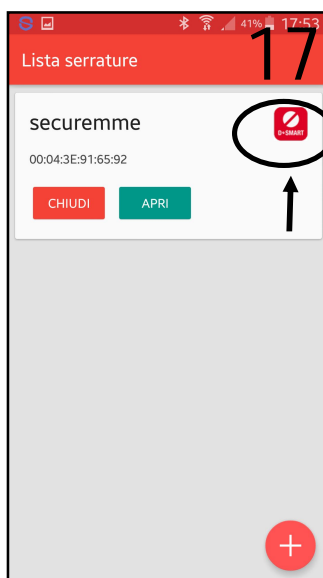
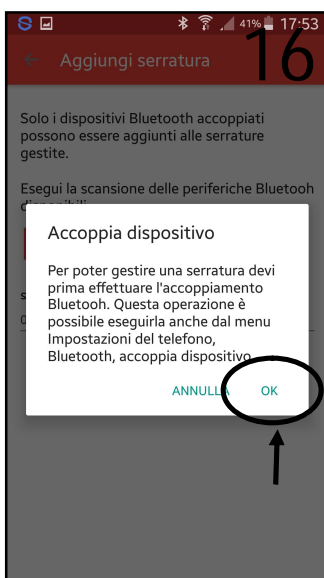
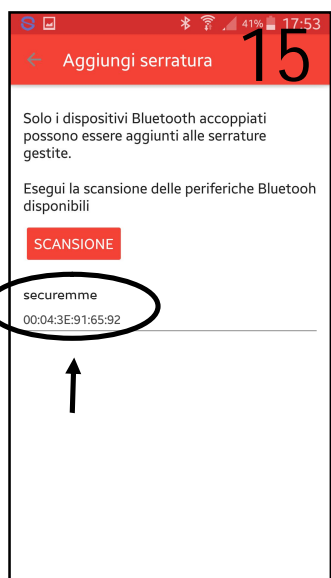
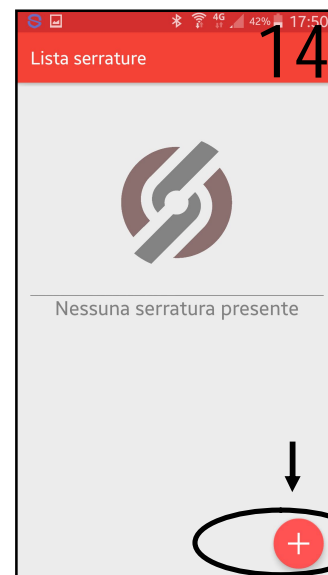
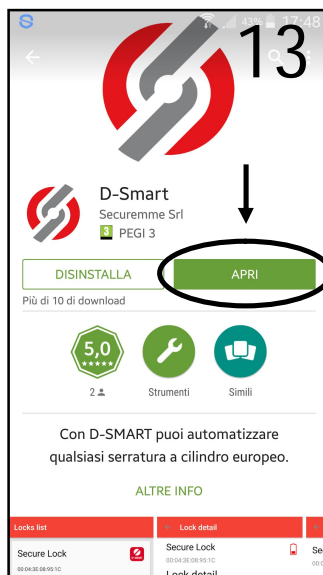
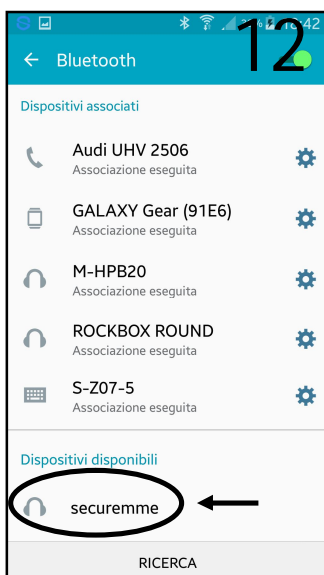
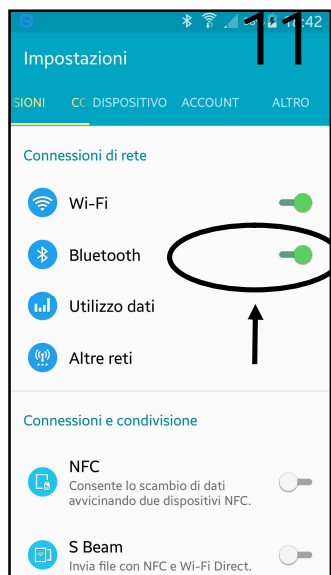

# D-SMART CONFIGURATION Installer

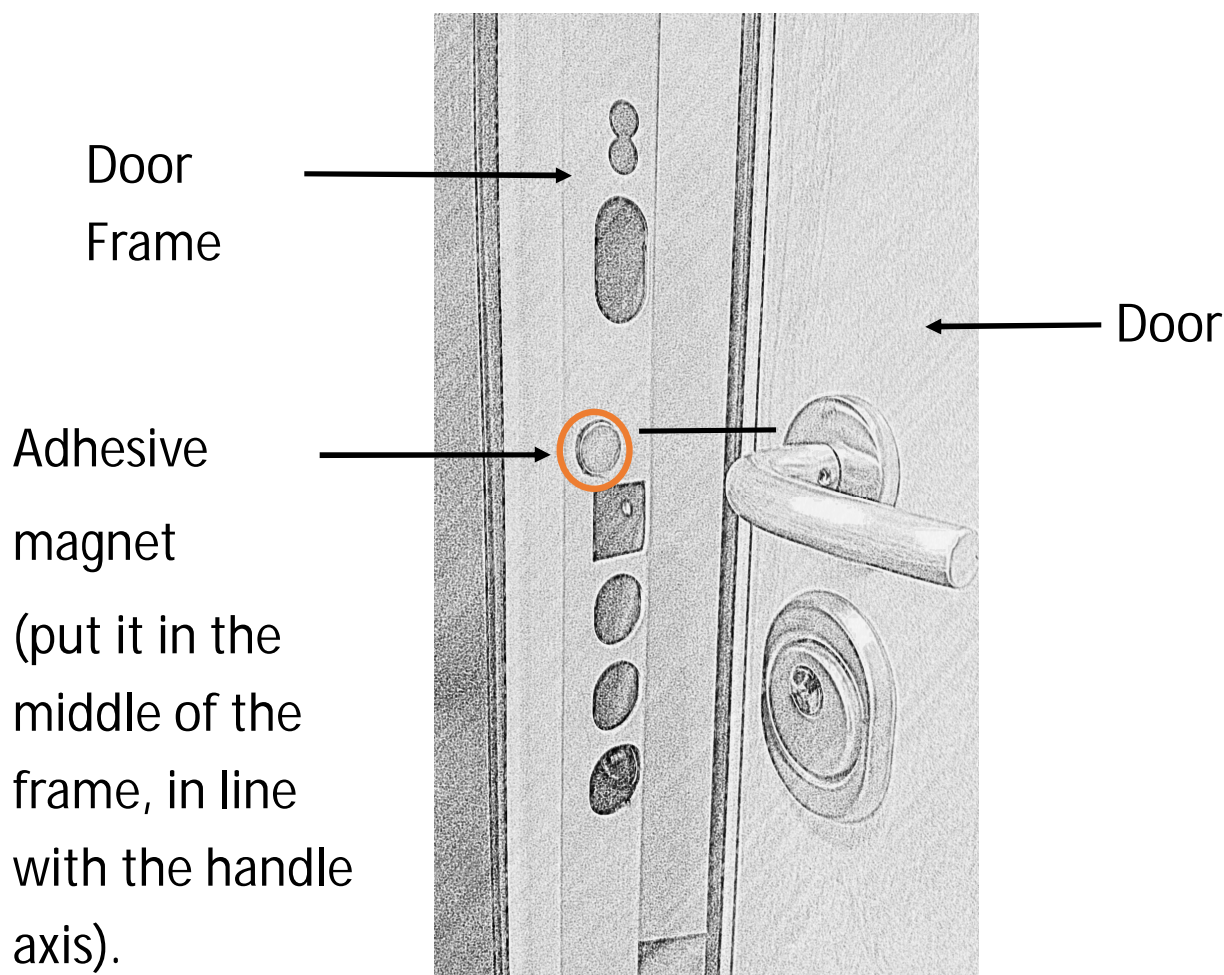
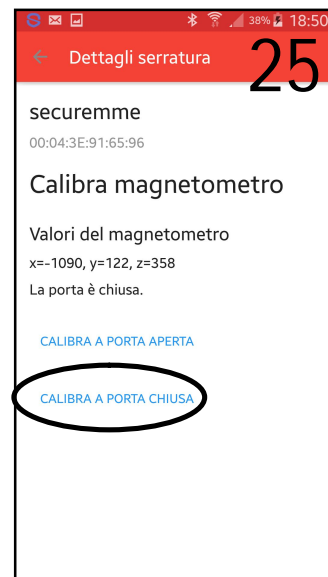
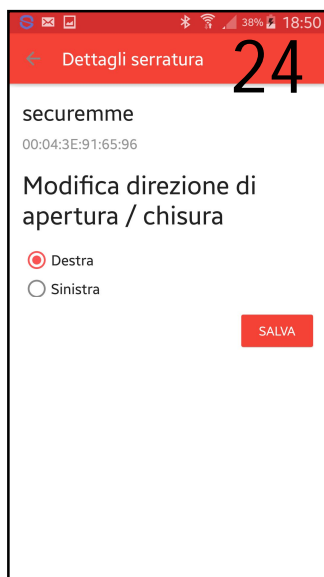

# D-SMART CONFIGURATION User

26. Activate the smartphone bluetooth and scan for new devices.
27. Connect it with the device having the default name **Securemme**.
28. Download the specific smartphone application by typing Dsmart or Securemme into the IOs, Android and Windows Phone store, then open it.
29. Add a new device by clicking on +
30. Click on *Scan* to find the Securemme device with its relative address.
31. Connect the device with the smartphone.
32. Click on the logo settings to get access to the lock detail.
33. Click on **CHANGE MASTER CODE**.
34. Attention: for the safety of the device change the factory master password (**master**) with a new password that must be between 6 and 10 characters and must contain at least a letter and a number. Click on *Update master code*. It is recommended to write down and to keep in a safe place the new password. If the password is lost it won't be possible to recover it and the intervention of the technical assistance will be necessary.
35. Go back to *Lock detail* and click *Key Managment* to adding new users.
36. Click on + to add new users (*New keys*).
37. Digit the new user name and password (the password must be between 6 and 10 characters and must contain at least a letter and a number), confirm the new password and save the new user.



# D-SMART CONFIGURATION User

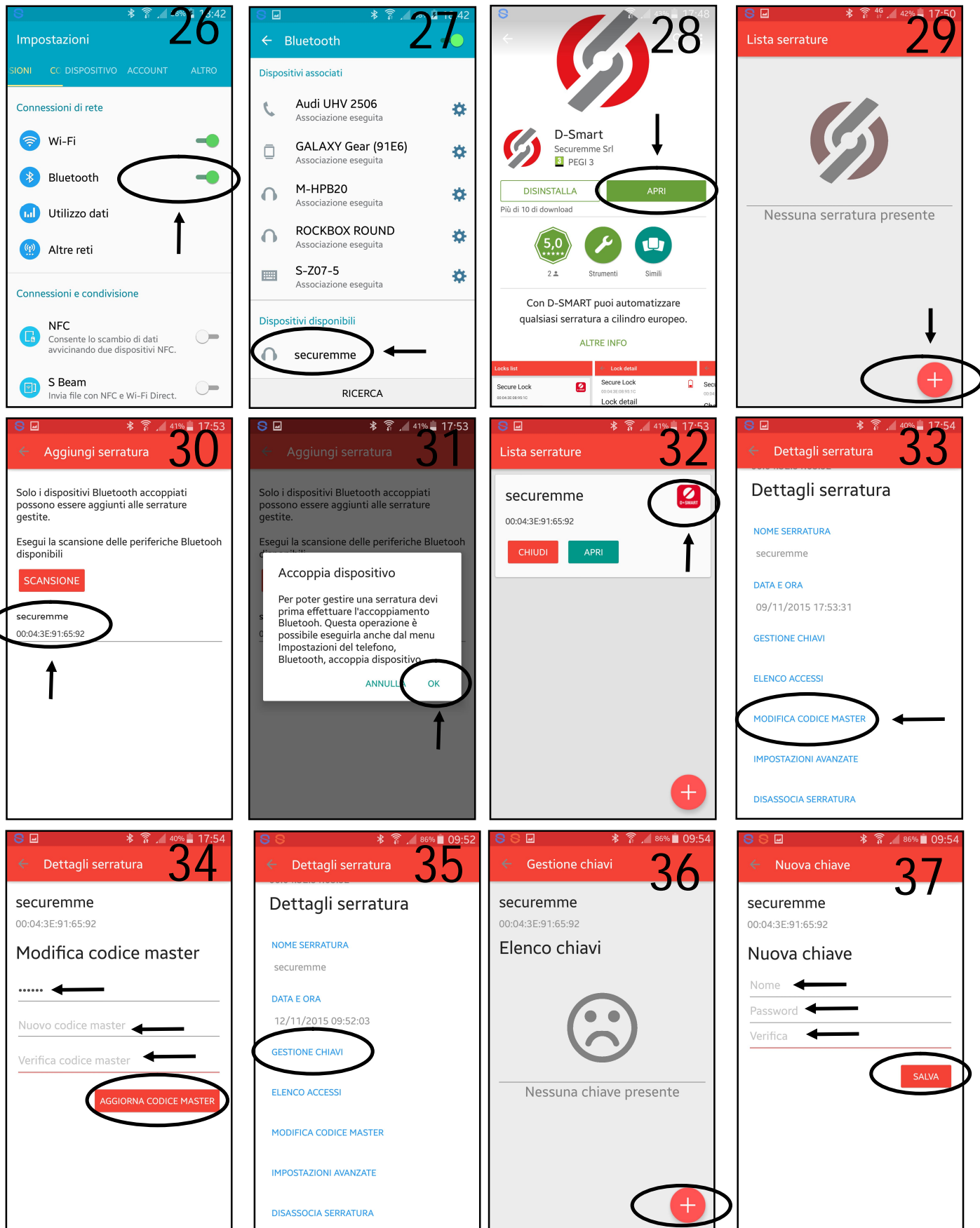



# D-SMART CONFIGURATION User

38. Once added the first user enter in *Key detail*.

*N.B. Also the owner/administrator of the door must know the credentials to access with the smartphone, transponder and/or numeric keypad.*

39. In the menu *Key Detail* click on *Change Access Method*.

40. Enable the user to the desired options: smartphone, transponder and/or numeric keypad.

41. For the transponder, check the field on the application and put the transponder next to the external numeric keypad. The device will give you a confirmation by automatically opening the latch of the lock.

For the numeric keypad, set the code of at least 4 characters and confirm it.

42. Check the user's credentials by clicking on *Show Credentials*.

43. By clicking on *Change Time Slot* is possible to enable every single user to more than one time slot per day (from Monday to Sunday).

44. In *Access List* you can see the last 30 accesses of every single user: next to every authorized access a green tick is present, while next to an unauthorized one there will be a red cross (X).

45. *Delete User*: go back to the Key details menu and click on *Delete Key*.

46. First user access with smartphone: go back to the homepage, click *Open* and only for the first time the user's credential previously created should be filled in.

47. Fill in the personal credentials (Name and Password) then click on *Save*.

48. In the case of faulty entry of Name and/or Password, go to the Lock Detail menu and click on *Forget Stored Key* (go back to point 46 and repeat the same operation).

49. To Eliminate the lock previously connected to your device click on *Disassociate Lock*.



# D-SMART CONFIGURATION User

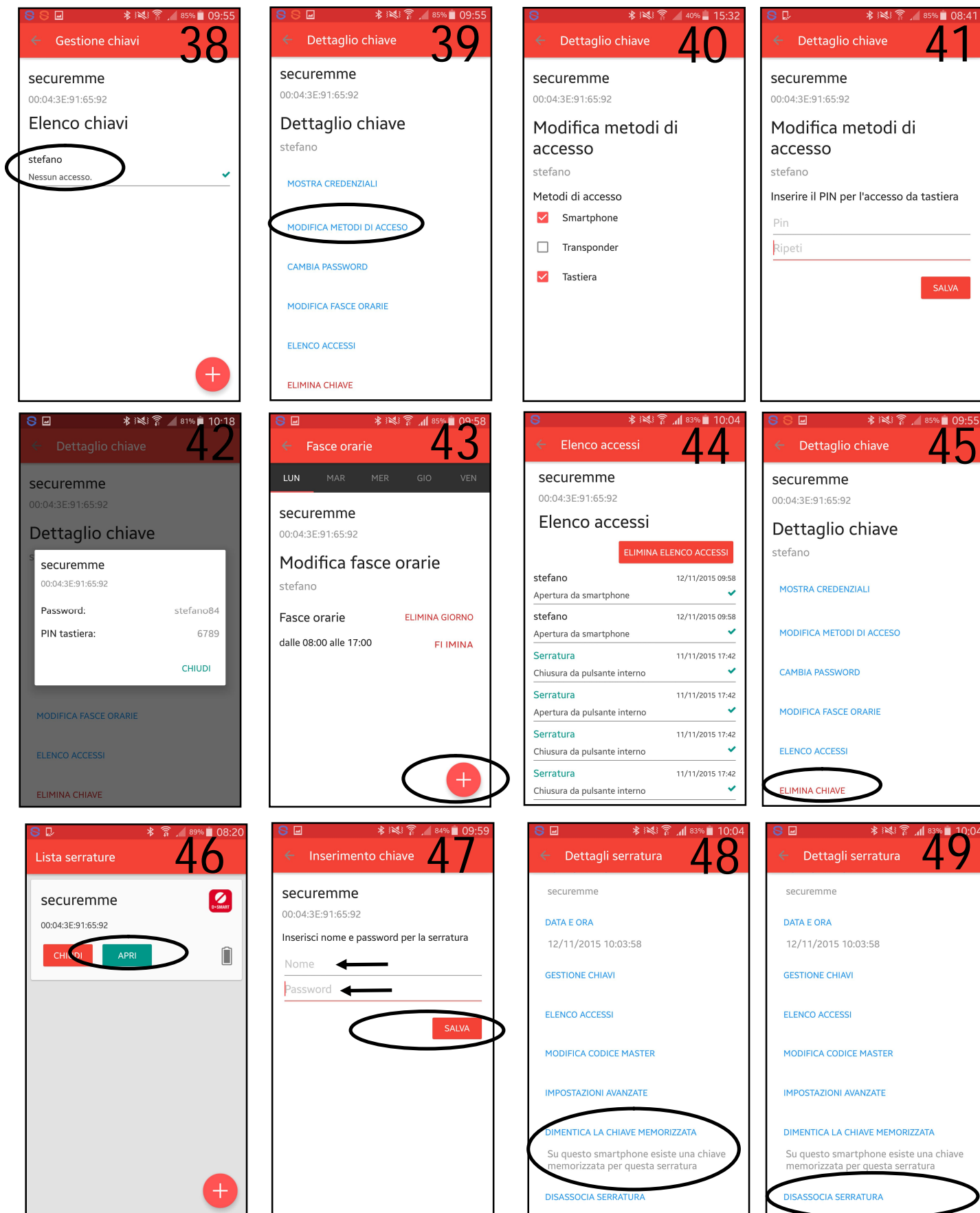

**D-SMART**

Make your lock motorized

# D-SMART CONFIGURATION User

## EXTERNAL NUMERIC KEYPAD

### Door opening with password:

Press 0 + password + E

### Door closing:

Press 0 + R

### Door opening with transponder:

Press 0 and place the transponder in the middle of the numeric keypad



## SPECIAL FUNCTIONS:

Function available only with external numeric keypad.

By digiting the password followed by **R**, the bluetooth system will turn off.

Once opened with transponder or with numeric keypad the bluetooth system will turn on for 2 minutes.

To turn it on again you must insert the shutdown code and then press **E**

ufftec  
00:04:3E:91:65:96

### Codice spegnimento

Codice:

Funzione attivabile solo da tastiera esterna. Inserendo il codice seguito da R, viene spento il bluetooth della serratura. Per riattivare il bluetooth bisogna inserire il codice seguito da E oppure inserire un codice associato ad una chiave

Codice

SALVA



# SCHEDULE D-SMART POWER GRID / CLEAN CONTACT

SCHEMA DI COLLEGAMENTO D-SMART  
CON ALIMENTAZIONE

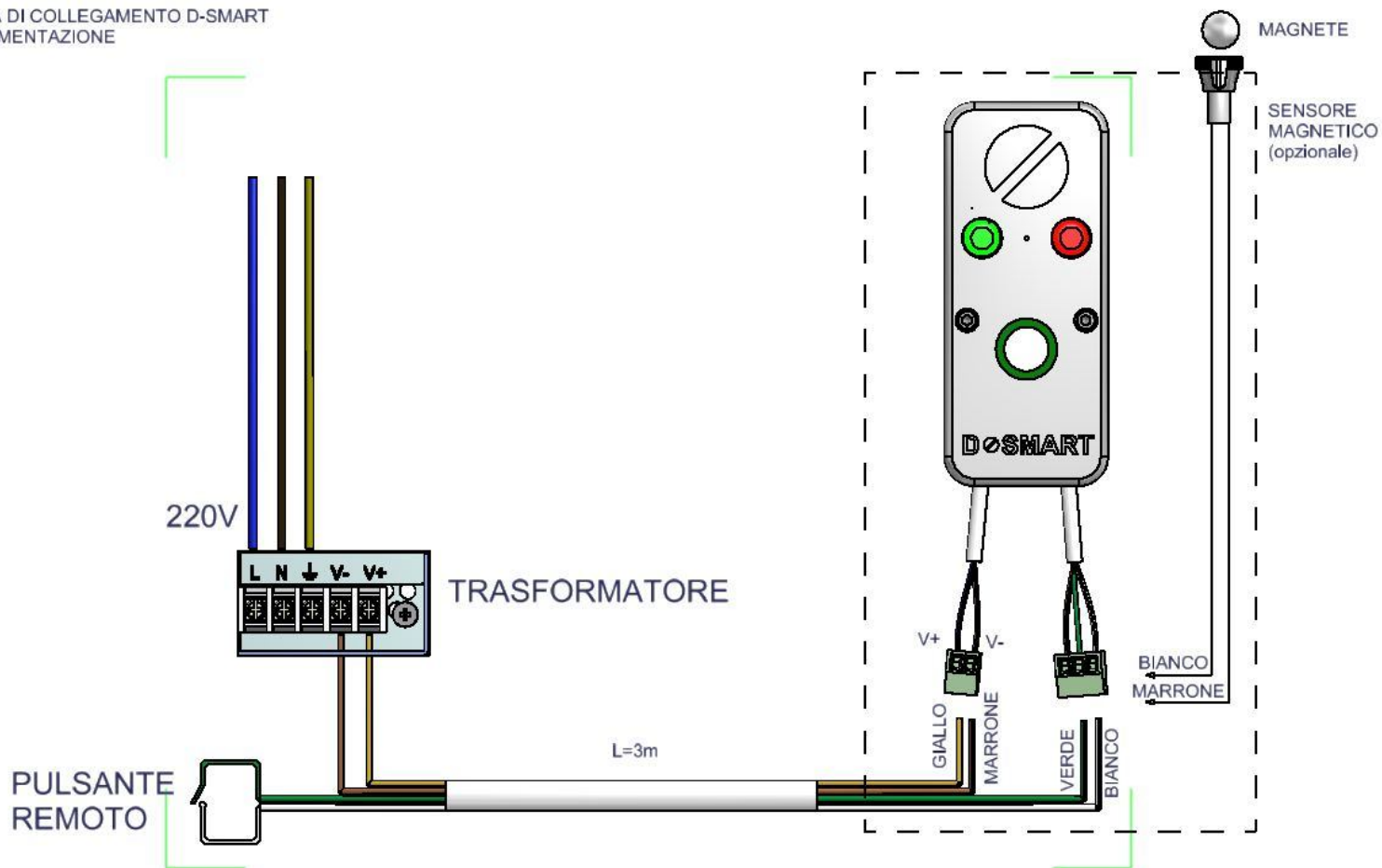

Intercom connection:

Use a relay that turns the powered contact in clean contact.

Connect the green and white connector (clean contact).

NOTE Use only the original Securemme transformer



# WARRANTY CONDITIONS

This product is warranted against malfunctions due to manufacturing defects. To be eligible for warranty you must keep this coupon

filled with data of the holder, together with the receipt or the tax document that proves the date of purchase. The warranty covers the replacement or the free repair of the defective parts found due to manufacturing defects, shipping fees excluded.

The warranty doesn't cover:

- damage due to installation not in accordance with the instructions given in this manual;
- the use of the device not correspondent to the operative mode illustrated here;
- aesthetic parts, electrical and electronic equipment damaged by negligent use, for unauthorized maintenance carried by staff,

shipment without due care, and in general for all those circumstances that cannot be attributed to manufacturing defects.

The compensation for direct and indirect damage caused to people or things resulting from the use or suspension of the system is

excluded. In case you need technical assistance, the customer is required to pay this intervention for the cost of transferring the

authorized technician.





# PRODUCT REVIEW

**If you are satisfied of our product rate with 5 stars after downloading the application**

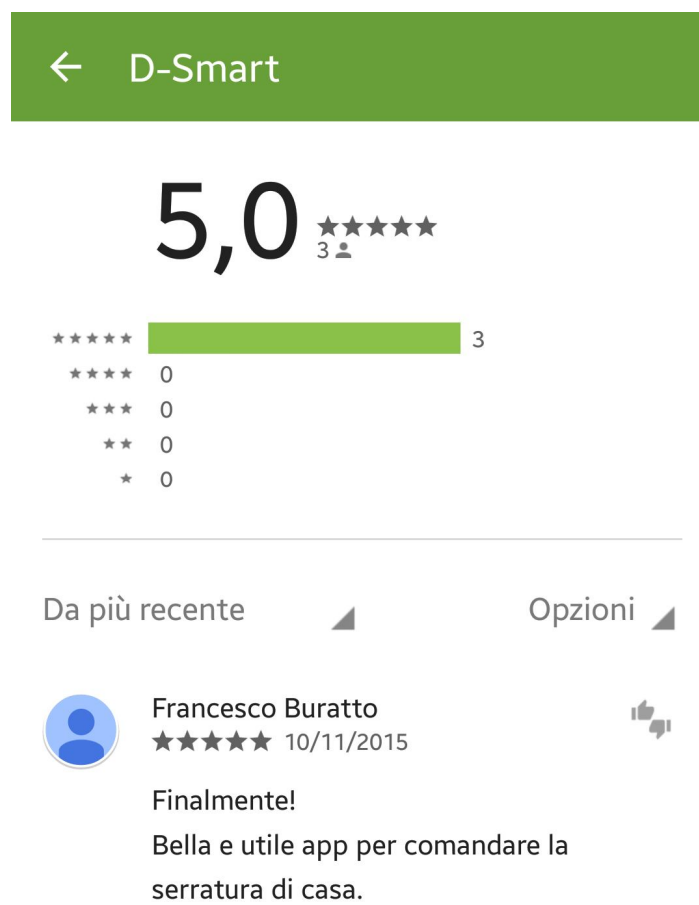

# D.SMART PAPER TEMPLATE

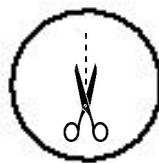

**CUT THE  
INTERIOR  
SIDE**

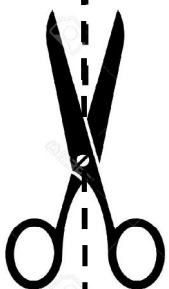

**D-SMART**

Make your lock motorized

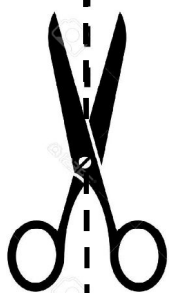

**D°SMART**

Make your lock motorized